



LaCie 2big Network



Professional 2disk RAID

Design by Neil Poulton

Shared Office Storage

Designed to satisfy the data sharing and backup needs of small offices, the LaCie 2big Network represents the new generation of shared storage with security. This unique Ethernet storage solution enables you to easily share professional files and to make them accessible from anywhere via FTP or HTTP. It can act as a file-sharing server, a backup server or an FTP server. Available network capacity can be expanded by attaching up to 2 USB hard drives.

Easy Setup & Access

The new user-friendly LaCie Ethernet Agent makes setup simple and enables accessing, mapping and configuring the drives on your office's network. The 2big Network's compatibility with Mac®, Windows® and Linux machines without having to install drivers make it the ideal file-sharing solution for small businesses.

RAID Flexibility

Get maximum storage capacity or extra data security in one affordable yet professional 2-disk RAID solution. Easily and quickly select your RAID mode with the manual switch on the back of the drive. For maximum capacity, choose BIG with concatenation of the two hard drives. For maximum protection, choose SAFE 100 (RAID 1) for automatic mirroring of one disk to the other (available capacity = 50%); if one disk fails, data remains accessible on the other one and the defective disk can be replaced easily with an optional hot-swappable disk.***

Superior Design

The heat sink metal design naturally draws heat away from the hard disk's internal components to help keep it cool and improve reliability. The 2big Network can be stacked or rackmounted to conform to every work environment. The large glowing blue button adds more than character – it functions as a 1-click data-sharing button for automatic file transfers from a USB key. Just push the button; your data is immediately sharable with your colleagues.

1TB* =

200,000 office presentations
or 250,000 songs
or 1000 movies***

- Share office files and back up data to a central location
- Mirrored volume for ensuring maximum protection against data loss
- Professional shared drive for Windows, Mac & Linux users
- Easy setup and access with LaCie Ethernet Agent

Features

- Ethernet for file sharing
- RAID 1 mode with automatic data-rebuilding
- 2 hot-swappable disks with locks
- 1-click data sharing for automatic file transfers
- 2 USB ports for storage expansion
- Heat sink metal design for natural cooling
- Configure vertically, horizontally or rackmounted

Box Content

- LaCie 2big Network
- Ethernet cable
- External power supply
- CD-ROM with User Manual and Utilities
- Quick Install Guide

Minimum System Requirements

- Ethernet switch or router
- PC or Mac equipped with a network adapter
- Intel Pentium 500MHz processor / G4 with Mac Intel 500MHz processor or greater
- Minimum 512MB RAM
- Web browser (Internet Explorer®, Safari®, Firefox®)

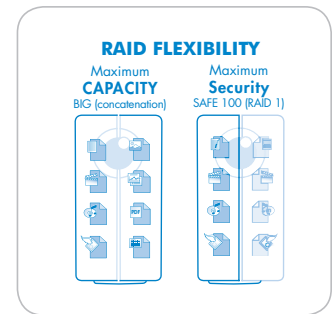
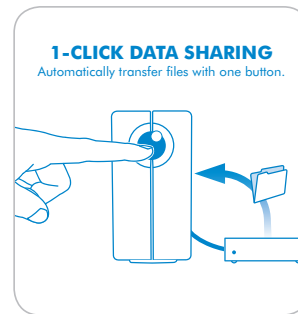

RACKMOUNTED



2 SWAPPABLE DISKS

LaCie 2big Network

Capacity*	1TB	1.5TB	2TB	
Item Number	301257	301258	301259	
Interface	1 x Gigabit Ethernet 10/100/1000 Mbps			
Rotational Speed / Cache	7200rpm / 1TB & 1.5TB: 16MB (each disk) or greater; 2TB: 32MB (each disk)			
Expansion Ports	2 x USB 2.0 for additional storage			
Processor / Memory	400MHz / DDR2 RAM			
Network Protocols	SMB (Windows/Linux); AFP (Mac); FTP; HTTP; Apple Bonjour			
Network Setting	New web-based management, Auto IP configuration (DHCP client compatible)			
RAID Modes	SAFE 100 (RAID 1): maximum security BIG (concatenation)			
Supported OS	Windows 98SE**, Window Me**, Window 2000, Window XP, Window Vista™ / Mac OS 9**, Mac OS X** or higher / Linux 2.4 or higher**			
Software	LaCie Ethernet Agent (for accessing, mapping & configuring drives on the network); LaCie '1-Click' Backup Software			
Cooling System	Thermoregulated, linear, quiet smart fan; heat sink metal design for natural cooling			
Dimensions	91 x 200 x 172 mm / 3.5 x 7.8 x 6.7 in.			
Weight	2630 g / 5.8 lbs.			
Warranty	3 year limited			

*1TB (Terabyte) = 1000GB. 1GB = 1,000,000,000 bytes. Total accessible capacity varies depending upon operating environment (typically 10–15% less). Capacity also varies depending upon RAID mode. BIG (concatenation) = 100% capacity; SAFE 100 (RAID 1) = 50% capacity.

**Not compatible with LaCie Ethernet Agent and '1-Click' Backup Software

***Calculations are based on 1GB/200 office presentations, 2.5MB/3-minute song, and 1GB/movie encoded in MPEG-4 or equivalent codec.

****Sold separately

© 2007, LaCie. The LaCie logo is a trademark of LaCie. Other product and brand names mentioned herein may be trademarks or registered trademarks of their respective owners. Specifications and appearance are given as guidelines and may change at any time without notice. www.lacie.com 070907

