

Table of Contents

1. Introduction	6
1.1. Minimum System Requirements	7
1.2. Supported Formats.....	7
1.3. Box Content	8
1.4. Languages.....	8
1.5. Views of the LaCinema Black RECORD	9
1.5.1. Front View.....	9
1.5.2. Status Light Behavior.....	9
1.5.3. Rear View.....	10
2. Using the Remote Control	11
2.1. Battery Installation.....	11
2.2. Remote Control Key Index.....	12
2.2.1. Important Button Details.....	13
3. Setting Up the LaCinema Black RECORD	14
3.1. STEP 1: Connect to TV	14
3.1.1. HDMI (High-Definition) Connection.....	15
3.1.2. Component & Analog Stereo Audio (High Definition) Connection	16
3.1.3. Composite & Analog Stereo Audio (Standard Definition) Connection	17
3.1.4. Optical Audio (S/PDIF) Connection	18
3.2. STEP 2: Connect to Set-Top Box or Digital Camcorder (Optional)	19
3.3. STEP 3: Connect the Power Supply	20
3.4. STEP 4: Turning on the TV	21
3.5. STEP 5: Complete the Installation Wizard.....	21
3.6. STEP 6: Connect to Your Network	26
3.6.1. Wireless Network Connection	26
3.6.2. Ethernet Network Connection	27
4. Playing Multimedia Files	28
4.1. Movie Space.....	28
4.1.1. Display format.....	29
4.1.2. Subtitle	29
4.1.3. Audio Languages.....	29
4.1.4. Play mode.....	30
4.1.5. Repeat.....	30
4.2. Photos Space.....	31
4.2.1. Transition.....	31
4.2.2. Rotate Left / Rotate right.....	31
4.3. Music Space	32
4.3.1. Repeat.....	32
4.3.2. Random.....	32
4.4. Playlist Management	33
4.4.1. To Create a New Playlist	33
4.4.2. Change Playlist Track Order.....	33
4.4.3. To Remove an Item from the Playlist	33
4.5. Record Space	34
4.6. Controlling Access to Files	35
4.7. Deleting Files.....	35

5. Playing & Copying Files from External Sources	36
5.1. USB Hard Drive	36
5.1.1. Connection	36
5.1.2. Compatibility	36
5.1.3. Playing Files	36
5.1.4. Copying Files	37
5.2. Transferring Files via USB (Requires Windows Media Player 11)	38
5.3. Networked Media Server	39
5.3.1. Network-Attached Hard Disk (NAS)	39
5.3.1.1. Playing Files	39
5.3.1.2. Copying Files	39
5.3.2. Host Computer	40
5.3.2.1. Playing Files Using TwonkyMedia Server (All users)	40
5.3.2.2. Copying Files Using TwonkyMedia Server (All users)	41
5.3.2.3. Playing Files via the Network Using Windows Media Player (Windows Only)	42
5.3.2.4. Copying Files via the Network Using Windows Media Player (Windows Only)	42
6. Capturing Video from a TV or Camcorder	43
6.1. Connect the External Video Source	43
6.2. Recording Video	43
6.2.1. Instant Recording	43
6.2.2. Scheduled Recording	44
6.2.3. Timeshifting: Taking Control of Live TV	45
6.2.4. Record Space Icon Details	45
6.3. Accessing Recorded Video	46
7. Settings Menu	47
7.1. Settings Menu Overview	47
7.1.1. Settings: General	47
7.1.2. Settings: Video/Photo	48
7.1.3. Settings: Connection	49
7.1.4. Settings: Network	49
7.1.5. Settings: Advanced	49
7.1.6. Settings: Version	49
7.2. Firmware Update	50
8. Troubleshooting	51
9. Contacting Customer Support	53
9.1. LaCie Technical Support Contacts	54
10. Warranty Information	55

Copyrights

Copyright © 2009 LaCie. All rights reserved. No part of this publication may be reproduced, stored in a retrieval system, or transmitted in any form or by any means, electronic, mechanical, photocopying, recording or otherwise, without the prior written consent of LaCie.

Trademarks

Apple, Mac, and Macintosh are registered trademarks of Apple Inc. Microsoft, Windows 98, Windows 98 SE, Windows 2000, Windows Millennium Edition, Windows XP and Windows Vista are registered trademarks of Microsoft Corporation. Other trademarks mentioned in this manual are the property of their respective owners.

Changes

The material in this document is for information only and subject to change without notice. While reasonable efforts have been made in the preparation of this document to assure its accuracy, LaCie assumes no liability resulting from errors or omissions in this document, or from the use of the information contained herein. LaCie reserves the right to make changes or revisions in the product design or the product manual without reservation and without obligation to notify any person of such revisions and changes.

Canada Compliance Statement

This Class B digital apparatus meets all requirements of the Canadian Interference-Causing Equipment Regulations.

FCC Statement

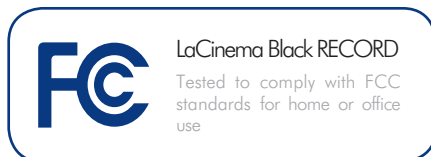

This device complies with Part 15 of the FCC Rules. Operation is subject to the following conditions:

1. The devices may not cause harmful interference
2. The devices must accept any interference received, including interference that may cause undesired operation.

NOTE: This equipment has been tested and found to comply with the limits for a Class B digital device, pursuant to Part 15 of the FCC Rules. These limits are designed to provide reasonable protection against harmful interference in a residential installation. This equipment generates, uses and can radiate radio frequency energy and, if not installed and used in accordance with the instructions, may cause harmful interference to radio communications. However, there is no guarantee that interference will not occur in a particular installation. If this equipment does cause harmful interference to radio or television reception, which can be determined by turning the equipment off and on, the user is encouraged to try and correct the interference by one or more of the following measures:

- ◆ Reorient or relocate the receiving antenna.
- ◆ Increase the separation between the equipment and receiver.
- ◆ Connect the equipment into an outlet on a circuit different from that to which the receiver is connected.
- ◆ Consult the dealer or an experienced radio/TV technician for help.

Modifications to this product not authorized by LaCie could void the FCC & Industry Canada regulations and negate your authority to operate the product.

CE Manufacturer's Declaration for CE Certification

We, LaCie, solemnly declare that this product conforms to the following European standards: Class B EN60950, EN55022, EN55024, EN61000-3-2:2000, EN61000-3-3: 2001

With reference to the following conditions: 73/23/EEC Low Voltage Directive; 89/336/EEC EMC Directive

Others

For Switzerland, Annex 2.15 of SR 814.81 applies for batteries

NOTE: The main cable must be in conformity with CEI 60227 or CEI 60245 and the type of plug must match the standards in the country of use.

CAUTION: Modifications not authorized by the manufacturer may void the user's authority to operate this device.

CAUTION: The LaCinema Black RECORD's warranty may be void as a result of the failure to respect the precautions listed above.



This symbol on the product, remote control batteries, or on its packaging indicates that this product must not be disposed of with your other household waste. Instead, it is your responsibility to dispose of your waste equipment by handing it over to a designed collection point for the recycling of waste electrical and electronic equipment. The separate collection and recycling of your waste equipment at the time of disposal will help to conserve natural resources and ensure that it is recycled in a manner that protects human health and the environment. For more information about where you can drop off your waste equipment for recycling, please contact your local city office, your household waste disposal service, or the shop where you purchased the product.

Health and Safety Precautions

- ◆ Only qualified persons are authorized to carry out maintenance on this device.
- ◆ Read this User Manual carefully and follow the correct procedure when setting up the device.
- ◆ Do not open a disk drive or attempt to disassemble or modify it. Never insert any metallic object into the drive to avoid any risk of electrical shock, fire, short-circuiting or dangerous emissions. The disk drives shipped with your LaCinema Black RECORD contain no user-serviceable parts. If it appears to be malfunctioning, have it inspected by a qualified LaCie Technical Support representative.
- ◆ Never expose your device to rain, or use it near water, or in damp or wet conditions. Never place objects containing liquids on the LaCinema Black RECORD, as they may spill into its openings. Doing so increases the risk of electrical shock, short-circuiting, fire or personal injury.
- ◆ Make sure that the computer and LaCinema Black RECORD are electrically grounded. If the devices are not grounded, there is an increased risk of electrical shock. Device power requirements 100-240 V~, 4A, 60-50 Hz, (Supply voltage fluctuations not exceeding $\pm 10\%$ of the nominal, transient over-voltages according to over-voltage category II). This product is also designed for IT power distribution system with phase-to-phase voltage 230V.

detect a problem, see the Troubleshooting section in this manual.

CAUTION: A shielded-type power cord is required in order to meet FCC emission limits and also to prevent interference to the nearby radio and television reception. It is essential that only the supplied power cord be used.

General Use Precautions

- ◆ Do not expose the LaCinema Black RECORD to temperatures outside the range of 5° C to 30° C (41° F to 86° F); or to operational humidity beyond 5-80%, non-condensing, or non-operating humidity beyond 10-90%, non-condensing. Doing so may damage the LaCinema Black RECORD or disfigure its casing. Avoid placing your LaCinema Black RECORD near a source of heat or exposing it to sunlight (even through a window). Inversely, placing your LaCinema Black RECORD in an environment that is too cold or humid may damage the unit.
- ◆ Always unplug the LaCinema Black RECORD from the electrical outlet if there is a risk of lightning or if it will be unused for an extended period of time. Otherwise, there is an increased risk of electrical shock, short-circuiting or fire.
- ◆ Use only the power supply shipped with the device.
- ◆ Do not place objects on top of the LaCinema Black RECORD or use excessive force on it.
- ◆ Never use excessive force on your LaCinema Black RECORD. If you

Operating Environment Temperatures

- ◆ Do not expose the LaCinema Black RECORD to temperatures outside the range of 5° C to 30° C (41° F to 86° F). As high end audio/video appliance, the LaCinema Black RECORD has been designed with an efficient ventilation system. Allow 5 cm of clearance for airflow on all sides of the LaCinema Black RECORD to prevent overheating. See [Fig. 01](#).
- ◆ Do not stack objects on top of the LaCinema Black RECORD, as they may interfere with the built-in WiFi antenna. See [Fig. 02](#).

IMPORTANT INFO: Any loss, corruption or destruction of data while using a LaCie drive is the sole responsibility of the user, and under no circumstances will LaCie be held liable for the recovery or restoration of this data. To help prevent the loss of your data, LaCie highly recommends that you keep **TWO** copies of your data; one copy on your external hard disk, for instance, and a second copy either on your internal hard disk, another external hard disk or some other form of removable storage media. LaCie offers a complete line of CD and DVD drives. If you would like more information on backup, please refer to our website.

IMPORTANT INFO: 1GB = 1,000,000,000 bytes. 1TB = 1,000,000,000,000 bytes. Once formatted, the actual available storage capacity varies depending on operating environment (typically 5-10% less).

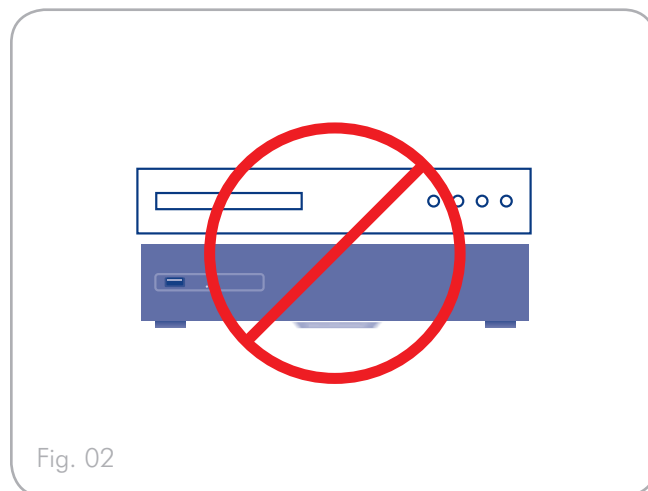
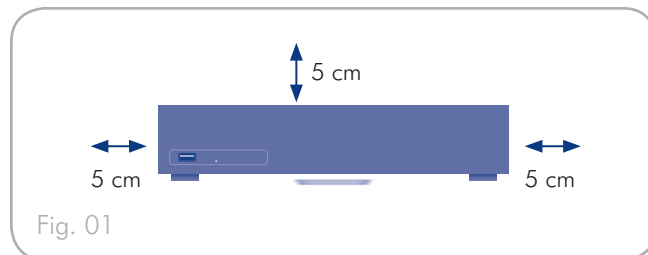

1. Introduction

Congratulations on the purchase of your new LaCinema Black RECORD! A premium media center, LaCinema Black RECORD plugs directly into a wide array of audio/visual equipment for instant playback of digital TV, home movies, music or photos.

Featuring the most advanced technologies, the LaCinema Black RECORD brings HD Digital TV, Live TV recording, Audio Video encoding and a UPnP network media player together in an elegant glossy black design.

To get started, simply connect the LaCinema Black RECORD to your TV and use the included remote to easily navigate through the menus, called [Spaces](#), to watch and record TV, listen to music, view photos or watch High definition movies.

LaCinema Black RECORD has been design to offer a new media experience providing ease of use in combination with the latest available technologies.

Quick Links

Click a topic:

- ◆ [Setting Up the LaCinema Black RECORD](#)
- ◆ [Playing Multimedia Files](#)
- ◆ [Capturing Video from a TV or Camcorder](#)



1.1. Minimum System Requirements



Windows Users

- ◆ 500 MHz Intel Pentium II or later
- ◆ Windows 2000, XP or Vista
- ◆ 256 MB RAM
- ◆ USB interface port
- ◆ Internet connection (for downloading updates)



Mac Users

- ◆ Intel Core Duo
- ◆ Mac OS 10.3.9
- ◆ 1 GB RAM
- ◆ UPnP Media Server to stream content to your LaCinema Black RECORD
- ◆ Internet connection (for downloading updates)

1.2. Supported Formats

Video Codecs	MPEG-1, MPEG-2 / HD, MPEG-4, DIVX, XVID, H.264 HD, WMV9 HD
Video Format	AVI, DIVX, MPG, MP4, MKV, WMV, MOV, ISO, VOB, IFO, ASF, TS, TP, TRP, M2TS
Max Decoding Resolution	1920 x 1080p
Mac Display Resolution	1080i
Upscaling	1080i for standard definition movies
Audio	MP3, WMA, AAC, OGG, AC3, MP4, WAV/ LPCM
Playlist	M3U
Recording format	MPEG2 TS at resolution 720x576p
DTS	Pass-through to compatible audio amplifier
Photo	Lossless JPEG (excluding progressive JPEG), PNG, GIF, BMP, TIF
Output	<ul style="list-style-type: none"> ◆ Video: HDMI, Component (YUV), Composite (CVBS) ◆ Audio: Optical Audio, Audio Stereo

Input	<ul style="list-style-type: none"> ◆ Video: Analog composite video or S-Video ◆ Audio: Analog stereo audio
Network	<ul style="list-style-type: none"> ◆ Ethernet 10/100 Mbps ◆ WiFi (802.11n)
TV Systems	PAL / NTSC
TV	Digital Terrestrial Television (DVB-T); High definition supported
File Systems (external USB drive)	<ul style="list-style-type: none"> ◆ NTFS (read/write) ◆ FAT32 (read/write) ◆ HFS+ (read only) (HFS+ Journaled is NOT supported)

1.3. Box Content

Your LaCinema Black RECORD package contains the system tower and an accessories box containing the items listed below.

1. LaCinema Black RECORD
2. Remote control
3. 2 x AAA batteries
4. Component 3xRCA Male/Male cable
5. Composite/2 audio RCA Male/Male cable
6. S-Video Male/Male cable
7. SCART to S-Video/Composite adapter
8. HDMI cable
9. USB cable
10. External power supply
11. Quick Install Guide
12. Utilities CD-ROM

IMPORTANT INFO: Please save your packaging. In the event that the drive should need to be repaired or serviced, it must be returned in its original packaging.

1.4. Languages

Supported Languages

- ❖ English
- ❖ French
- ❖ Italian
- ❖ German
- ❖ Spanish

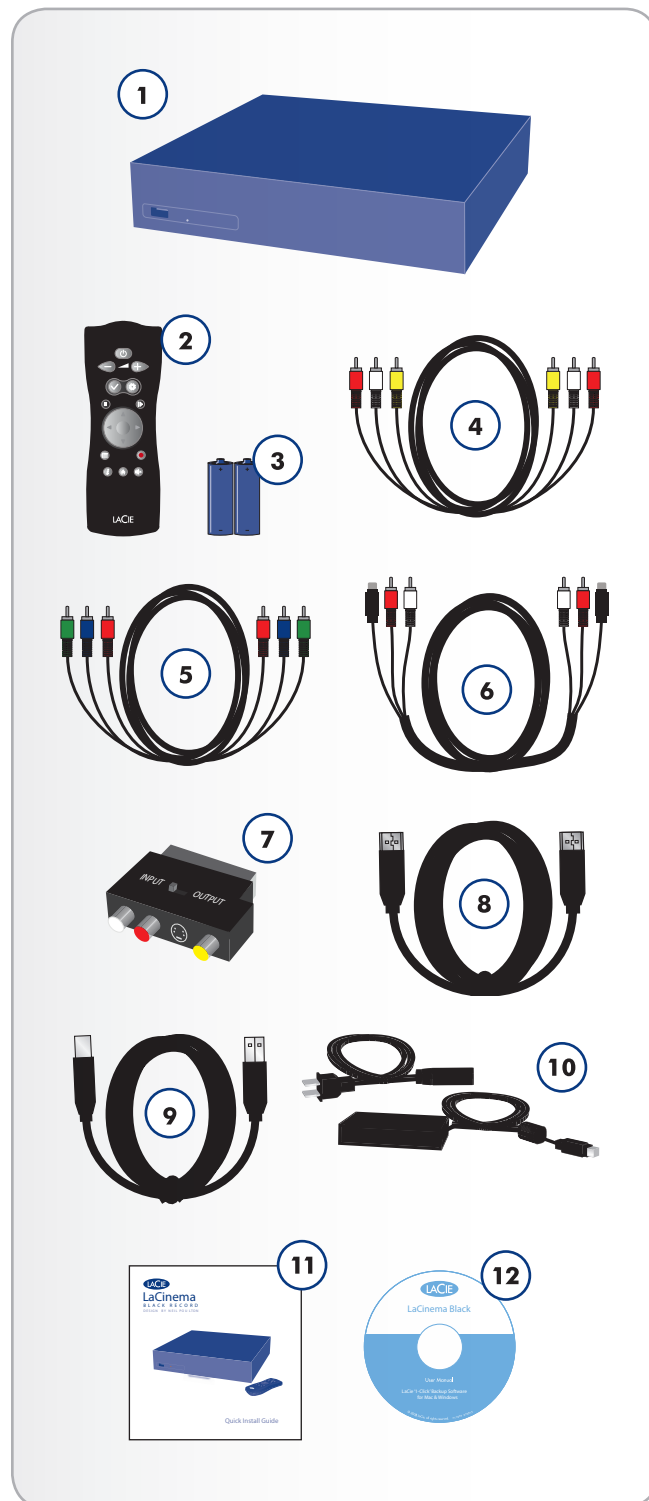

1.5. Views of the LaCinema Black RECORD

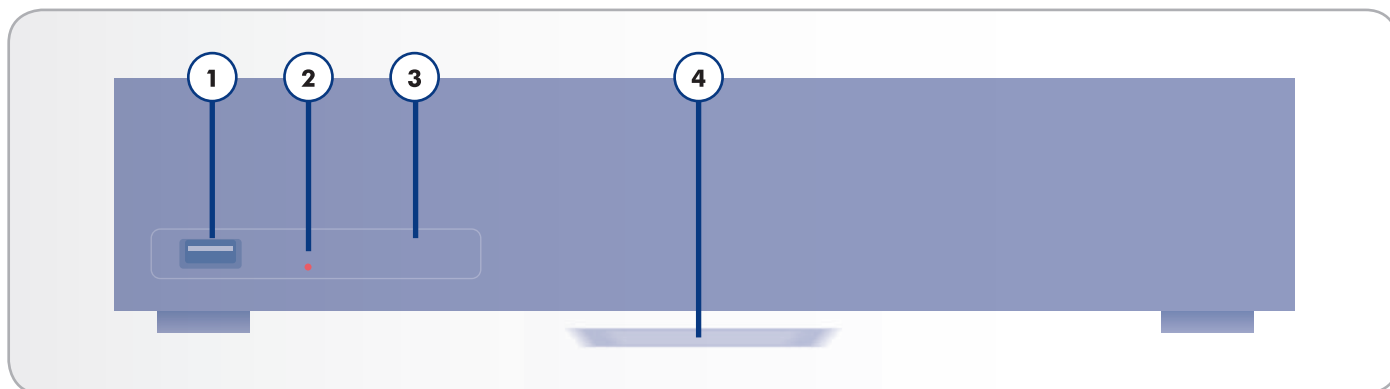

1.5.1. Front View

- 1. USB expansion port** – Connect a USB flash disk, hard disk or card reader to access its multimedia files directly from your TV.
- 2. Status light (Red)** – Indicates recording and product default resetting.
- 3. Infrared receiver** – Receives the infrared signal from the remote control. Make sure the receiver is not obstructed.
- 4. Status light** – See chart below.

1.5.2. Status Light Behavior

LaCinema Black RECORD behavior	Blue status light	Red status light
On	On	Off
Off or in Stand by	Off	Off
Starting up	On	Flashes for a few seconds before home screen appears
Playing video content	Off	Off
Resetting to default	On	On
Receiving a command from the remote	Flashes once	Off
Recording	Depends on other actions	On

1.5.3. Rear View

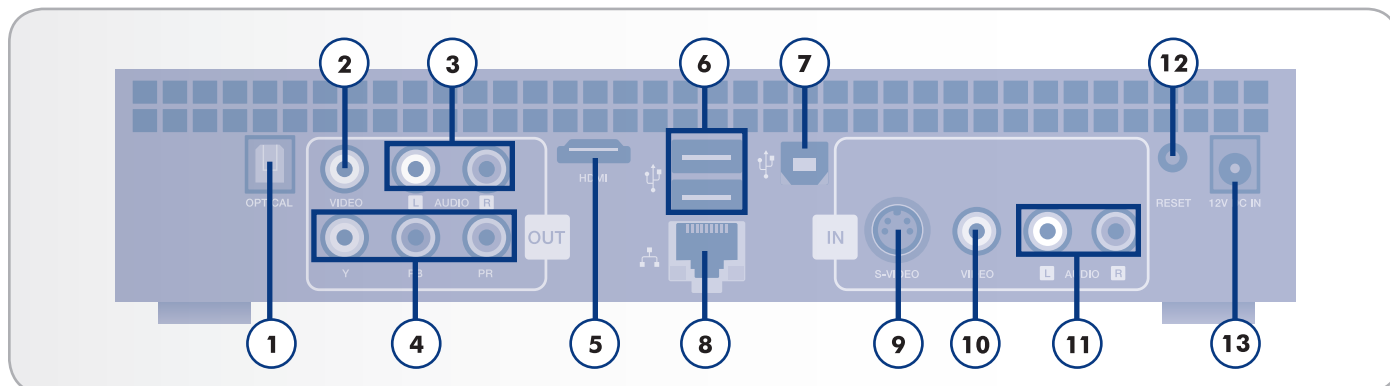

- 1. Digital Optical Audio OUT connector** – Use an optical digital audio cable (not included) to connect to your home theater system for digital sound
- 2. Composite Video (CVBS) OUT connector** – Composite video provides good video quality for non-high definition TV. Connect a separate cable for audio output.
- 3. Composite (Analog) Audio left (white) and right (red) OUT connectors** – Stereo audio provides good analog sound output
- 4. Component Video OUT connector** – Component Video provides high-definition picture up to 1080i using a Component Video cable. Connect a separate cable for audio (stereo cable or digital optical cable).
- 5. HDMI connector** – Connects to a TV, A/V receiver, or home theater system. HDMI provides a pure digital connection for high definition video and digital audio all in one cable. If your TV has a DVI (Digital Video Interface) jack, you can use an HDMI-to-DVI adapter (sold separately) for a digital video connection to your TV. You will need to connect a separate cable for audio.
- 6. USB 2.0 connector (for external disk connection)** – Connect USB external storage devices (such as hard disks or flash keys) or memory card readers to browse, play and manage content directly from your TV.
- 7. USB 2.0 connector (for PC connection)** – Connects to a computer in order to transfer multimedia files
- 8. Ethernet connector** – Connects to a network in order to transfer multimedia files
- 9. S-Video IN connector** – connects to an analogue video source for video capture
- 10. Composite Video (CVBS) IN connector** – connects to an analogue video source for video capture
- 11. Stereo Audio left (white) and right (red) IN connectors** – Connects to analog camcorders and projectors
- 12. Reset to Factory Settings button** – Press this button if your LaCinema Black RECORD does not respond. All the settings will be reset and the installation wizard will run.
- 13. External power supply connector** – Plug in the power supply

WiFi connection – Antenna is inside the product. Connect the LaCinema Black RECORD through WiFi to a network in order to transfer multimedia files

IMPORTANT INFO: Do not stack objects on top of the LaCinema Black RECORD, as they may interfere with the WiFi antenna.



TECHNICAL NOTE: Mac OS X users cannot directly connect the LaCinema Black to their computers via USB.

- 8. Ethernet connector** – Connects to a network in order to transfer multimedia files

2. Using the Remote Control

Some of the buttons of the remote control have different functions or no function at all depending on the type of file you are viewing. This chapter discusses the button functions for each type of file (movies, photos and music) and battery installation.

2.1. Battery Installation

The remote control uses two AAA batteries. The batteries are not pre-installed, so you will need to install them before you can use the remote control.

To install the batteries:

1. Remove the battery compartment cover.
2. Load the batteries onto the battery compartment. Position the batteries so that the “+” symbols on the batteries face the same direction as the “+” symbols on the battery compartment.
3. Slide the battery compartment cover back into the remote.

IMPORTANT INFO: If you will not be using the remote control for an extended period of time, LaCie recommends that you remove the batteries.

IMPORTANT NOTE: Make sure there is a clear path between the remote control and the LaCinema Black RECORD.



2.2. Remote Control Key Index

The LaCinema Black RECORD's remote control allows you to control the LaCinema Black RECORD while its connected to your TV or home theatre center.

Button	Function
1. Infra-red emitter	Sends signals to the LaCinema Black RECORD
2. Stand-by	Resume stand-by
3. Volume down	Adjust volume down
4. Volume up	Adjust volume up
5. Mark	Mark items for various actions; create playlist
6. Options/Settings	Action menu, Setup
7. Stop/Cancel	Stop the current file playback
8. Play/Pause/OK	Selects, plays, or pauses
9. Up/Down	Scroll through lists
10. Left/Right	Scroll through menus or fast forward/rewind
11. List	Show Record panel or file list
12. Record	Instant record
13. Information	File properties or movie information
14. Mute	Mute sound
15. Home	Go to home menu

[continued on the next page >>](#)

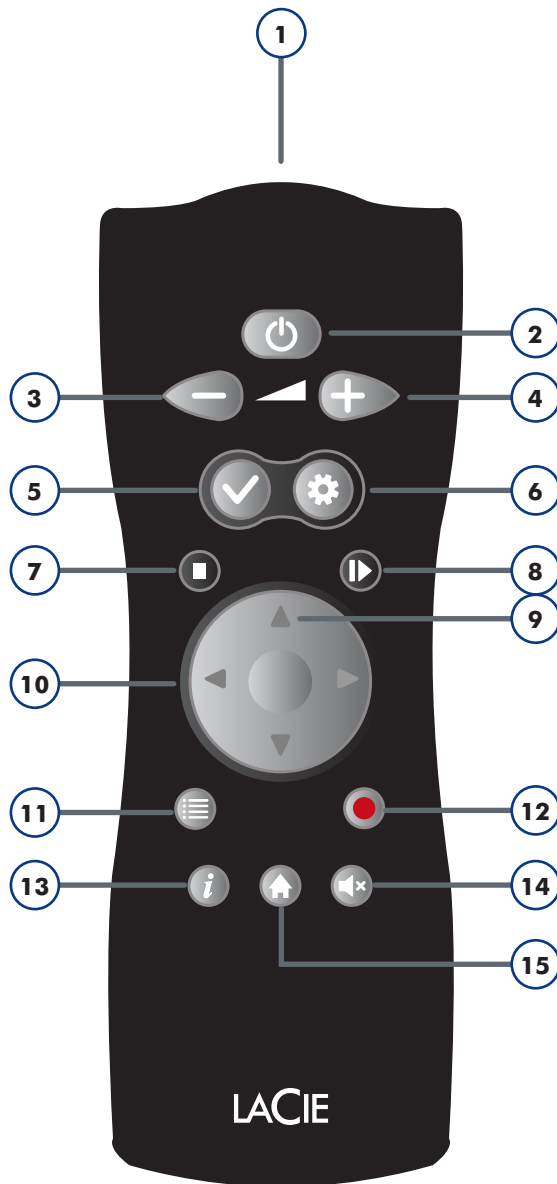

2.2.1. Important Button Details



Mark button: This button is used to mark or unmark a file or folder for future action, such as copy/paste or to create a playlist in the different media spaces.

Once the item is marked, the selected item's summary is displayed with the number of files and total size.

You can display the list of marked items by pressing the [Options/Settings](#)  button and selecting [Show Marked Item List](#) from the contextual menu.

The item's list should then be cleared by selecting [Unmark Marker List](#) from the contextual menu.

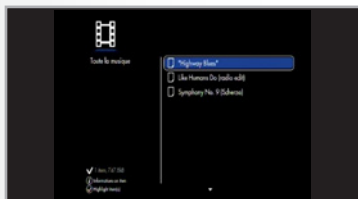

Options/Settings



button: This button is used to display the available settings or actions in the different media spaces.

From the [Home](#) menu, this button will direct you to the LaCinema's main [Settings](#) menu. In other media spaces or during playback, a contextual menu will be displayed with available actions.



Play/Pause/OK button: This button has two main functions, OK and Play/Pause. It allows you to confirm a selection and to start/pause playback in the different media spaces.

3. Setting Up the LaCinema Black RECORD

Setup consists of six steps:

- ◆ STEP 1: Connect to TV (section [3.1](#))
- ◆ STEP 2: Connect to Set-Top Box or Digital Camcorder (Optional) (section [3.2](#))
- ◆ STEP 3: Connect the Power Supply (section [3.3](#))
- ◆ STEP 4: Turning on the TV (section [3.4](#))
- ◆ STEP 5: Complete the Installation Wizard (section [3.5](#))
- ◆ STEP 6: Connect to Your Network (section [3.6](#))

3.1. STEP 1: Connect to TV

The LaCinema Black RECORD supports different ways of connecting to televisions. From the following methods, choose the setup that matches the ports on your television or receiver:

- ◆ HDMI (section [3.1.1](#))
- ◆ Component (section [3.1.2](#))
- ◆ Composite (section [3.1.3](#))

In each of the above connection methods, it is possible to connect the LaCinema Black RECORD to home theater systems by plugging an S/PDIF cable (not included) to your digital amplifier via the digital optical audio connector (see section [3.1.4. Optical Audio \(S/PDIF\) Connection](#) for details).

The chart at right illustrates the qualities made possible by the different connection methods.

Definition	Connection	Max Display Resolution
High Definition	HDMI	1080i
	Component	1080i
Standard Definition	SCART RGB	576p
	Composite	576p

TECHNICAL NOTE: The connectors on the rear of your TV may not appear exactly the same as shown below. Please read the labels next to the connectors carefully to ensure correct connections.

[continued on the next page >>](#)

3.1.1. HDMI (High-Definition) Connection

IMPORTANT INFO: Before connecting the cable, power off your TV.

1. Connect one end of the HDMI cable to your television's HDMI port ([Fig. 04](#)).
2. Connect the other end to the HDMI port on the back of the LaCinema Black RECORD.

Move on to the next step, [3.2](#).

TECHNICAL NOTE: If your TV's HDMI port is being used by another device, or if your TV doesn't have an HDMI port, you can connect to the TV using Composite or Component (see section [3.1.2](#) or [3.1.3](#) for details).

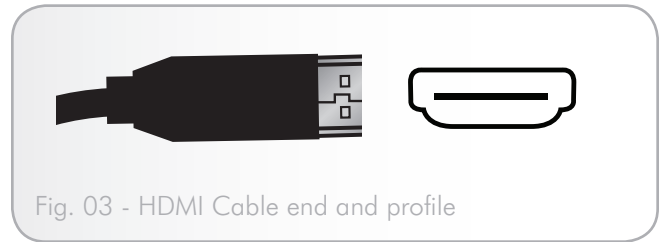

Fig. 03 - HDMI Cable end and profile

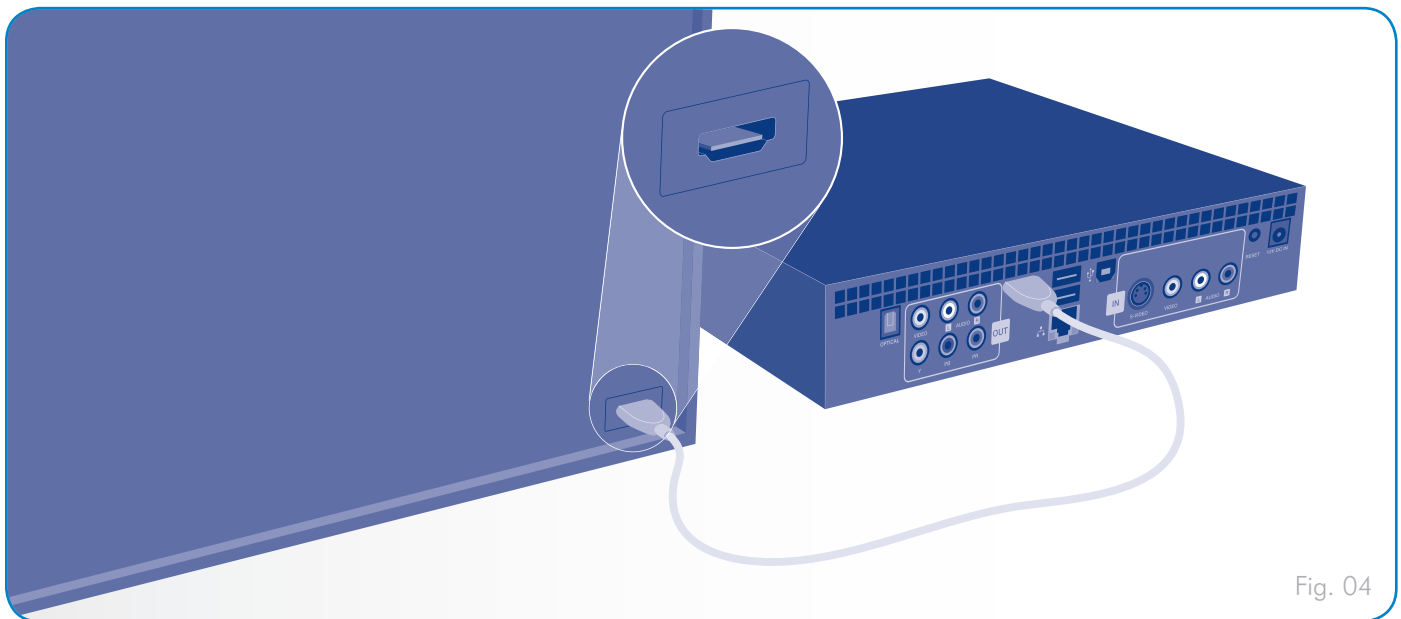



Fig. 04

3.1.2. Component & Analog Stereo Audio (High Definition) Connection

IMPORTANT INFO: Before connecting the cables, power off your TV.

1. Connect one end of the component (red, green, and blue) video cable to the component ports on your TV (Fig. 06). For Audio output, connect the stereo audio cable (with red and white ends) to the stereo audio port on your TV. The stereo audio connectors you should use are usually located close to the TV's component ports.
2. Connect the other end of the component connectors to the three corresponding ports (red, green, and blue for video and white and red for audio) on the back of the LaCinema Black RECORD.
3. If you choose to use this connection method you will have to change the Component mode using the remote control. After turning on the television (see section 3.3 for details), press the [Options/Settings](#)  button to navigate to the [Settings Space](#), and set the Component mode to YUV in the Video or Photo section.

Move on to the next step, [3.2](#).

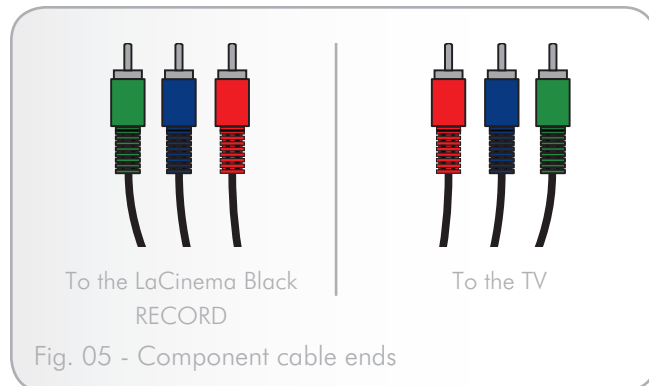

Fig. 05 - Component cable ends

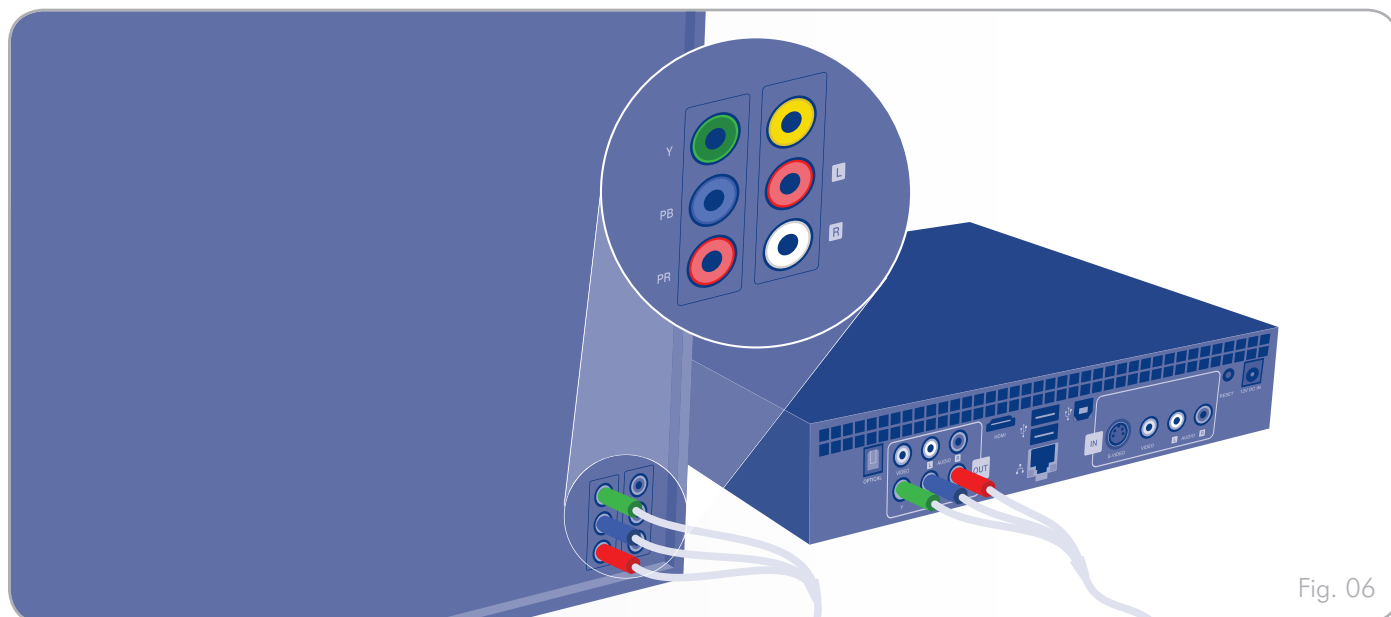

Fig. 06

3.1.3. Composite & Analog Stereo Audio (Standard Definition) Connection

IMPORTANT INFO: Before connecting the cables, power off your TV.

1. Connect the yellow connector on one end of an analogue composite/stereo cable to the CVBS port on your TV (Fig. 08).
2. Connect the yellow connector on the other end of the composite/stereo cable to the LaCinema Black RECORD
3. Connect the analog audio parts of the cable (red and white connectors), to your TV and to the LaCinema Black RECORD.

Move on to the next step, [3.2](#).

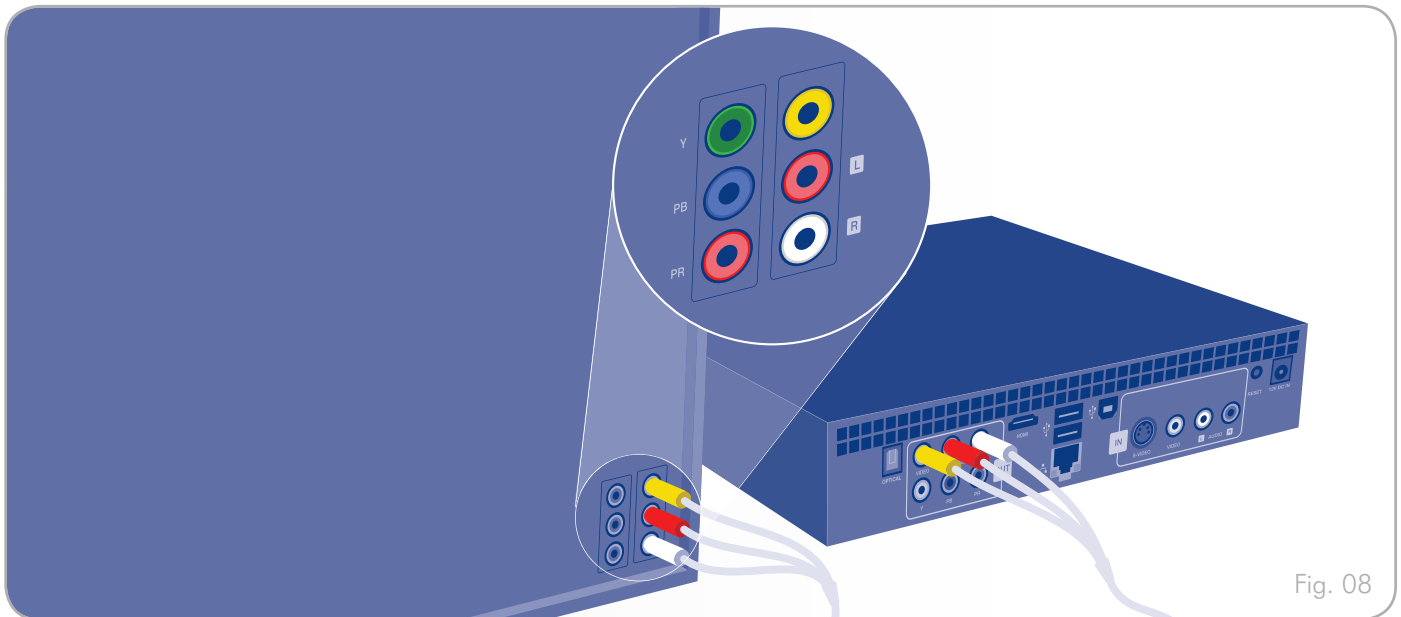
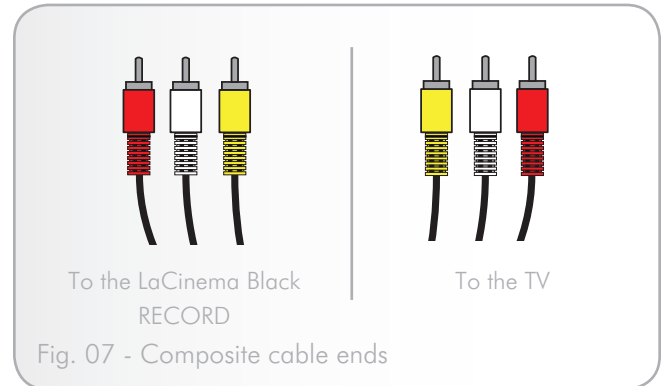

3.1.4. Optical Audio (S/PDIF) Connection

IMPORTANT INFO: Before connecting the cable, power off your digital amplifier.

In each of the above connection methods, it is possible to connect the LaCinema Black RECORD to home theater systems by plugging the S/PDIF cable (not included) into your digital amplifier via the LaCinema Black RECORD's digital optical audio connector.

1. Connect one end of a S/PDIF cable to your digital amplifier (Fig. 10).
2. Connect the other end of the cable to the back of the LaCinema Black RECORD.

Move on to the next step, [3.2](#).

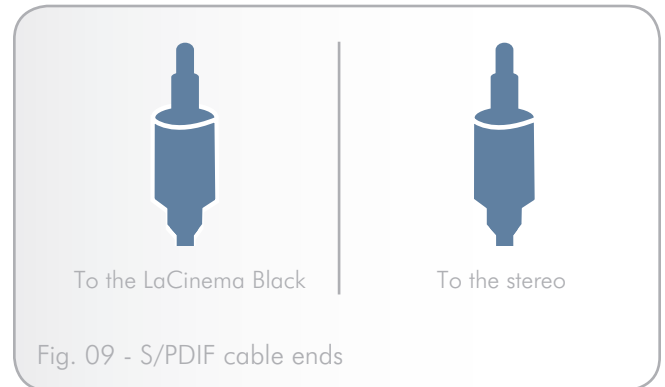

Fig. 09 - S/PDIF cable ends

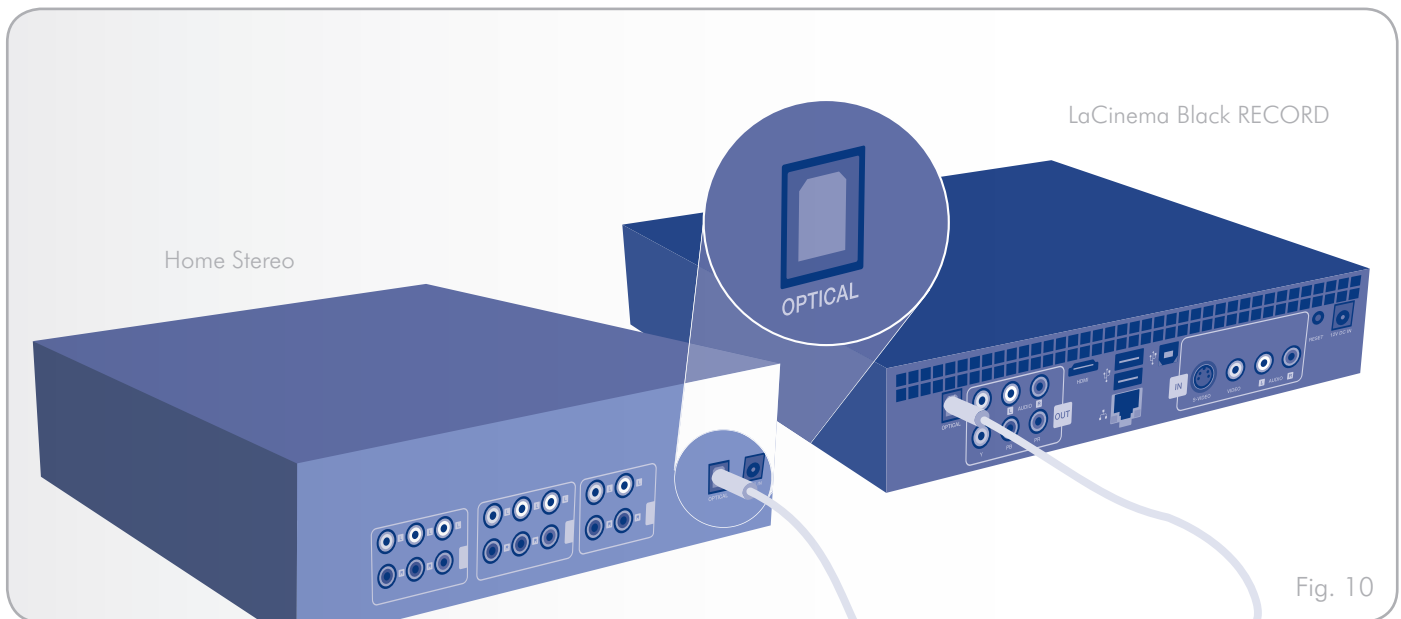

Fig. 10

3.2. STEP 2: Connect to Set-Top Box or Digital Camcorder (Optional)

You can connect the LaCinema Black RECORD to a set-top box or digital camcorder in order to watch and record video using the LaCinema Black remote control.

1. Connect the white and red cable ends to the LaCinema Black and to the set-top box or camcorder.
2. Connect either the yellow end of the composite cable or the S-Video cable (shown in [Fig. 11](#) and [Fig. 12](#)) to the LaCinema Black and to the set-top box or camcorder.
3. Set the proper video setting: Using the LaCinema Black remote control, press the **Up ▲** and **Down ▼** buttons to select either **IN S-Video** (if you used the S-Video cable) or **IN Video** (if you used the composite cable) ([Fig. 13](#)).

Move on to the next step, [3.3](#).

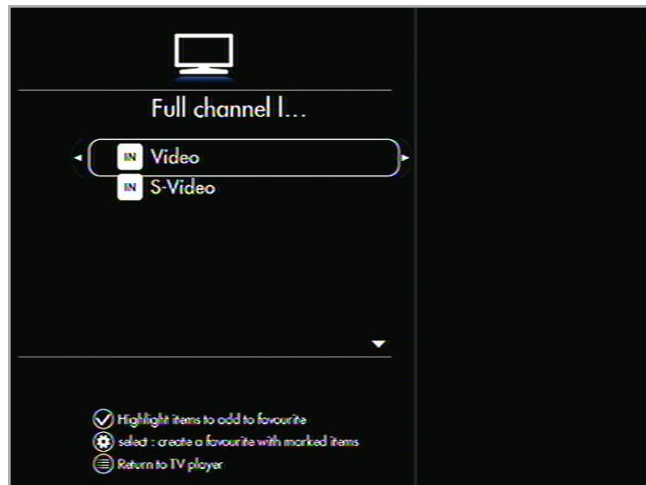
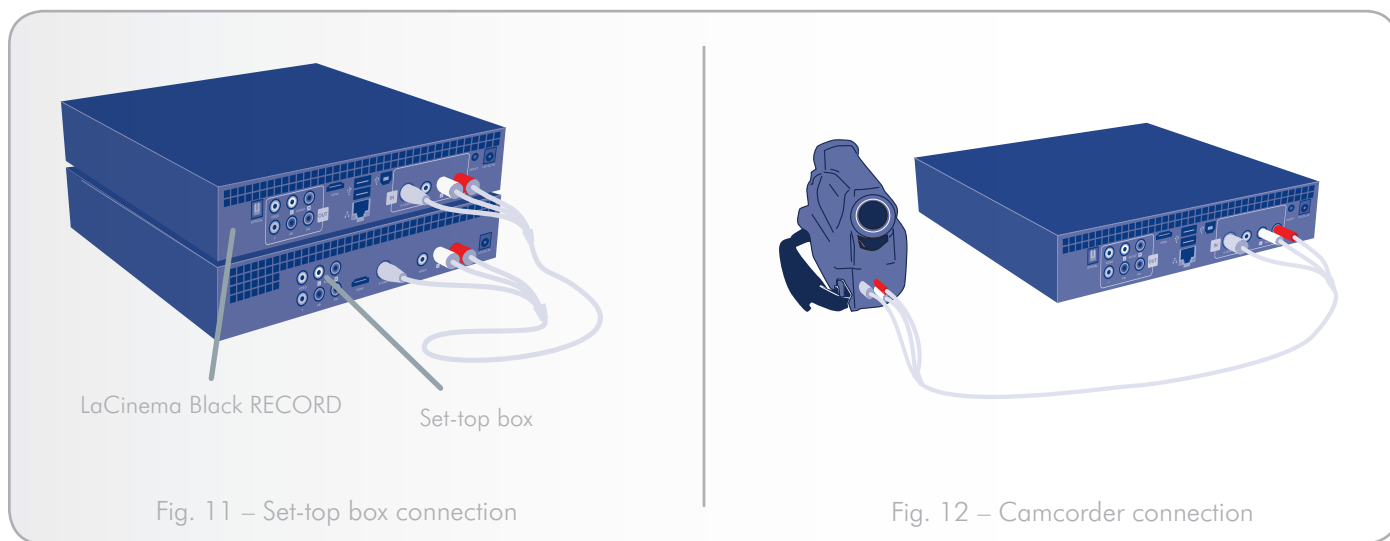

Fig. 13



3.3. STEP 3: Connect the Power Supply

Plug one end of the power adapter cord into the back of LaCinema Black RECORD and the other end into a power outlet (Fig. 14).

Move on to the next step, 3.4.

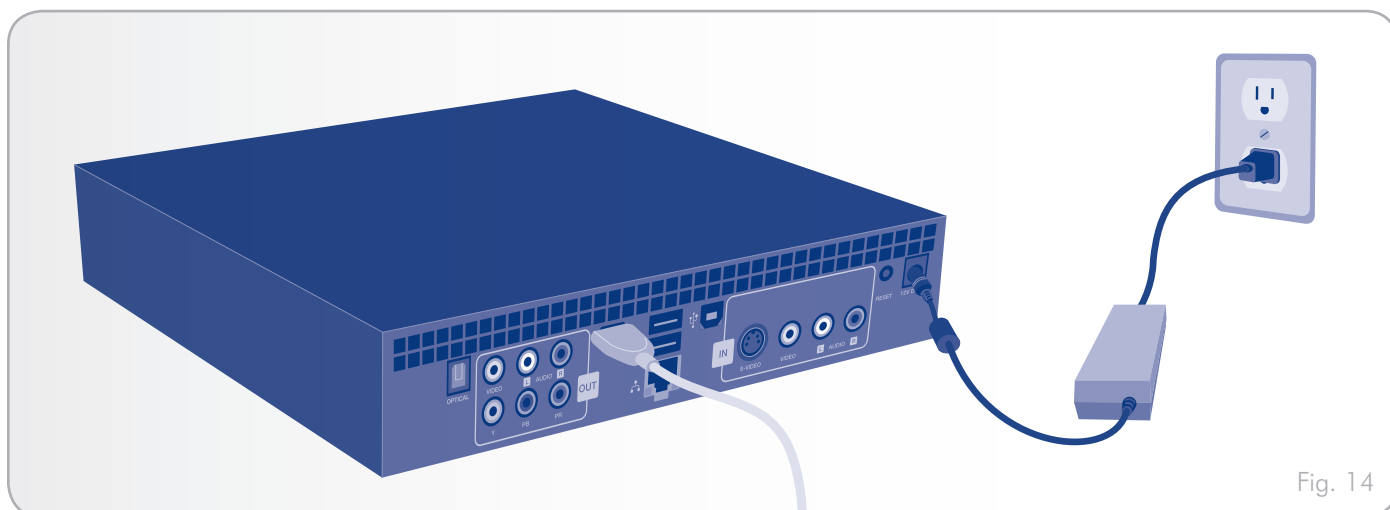

Fig. 14

3.4. STEP 4: Turning on the TV

Turn on the television.

If you don't see the loading screen, adjust the video input on your TV to match the type of video cable you connected above (Fig. 15).

Move on to the next step, 3.5.

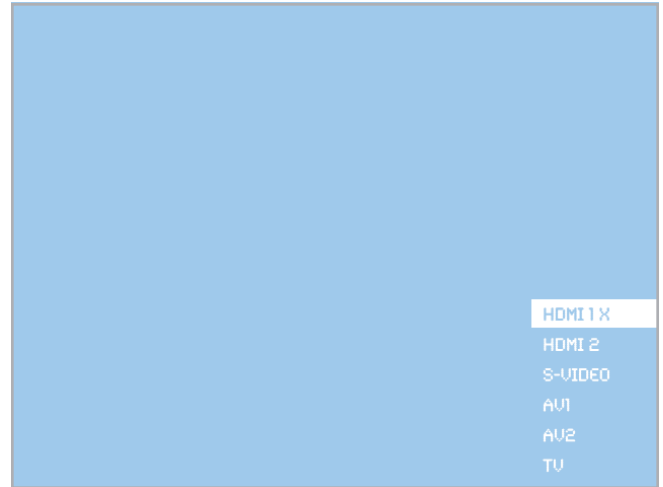

Fig. 15

3.5. STEP 5: Complete the Installation Wizard

The first time you turn on the LaCinema Black RECORD, a wizard appears to help you configure your settings. The wizard appears only the first time you turn on the LaCinema Black RECORD unless you have pressed the reset button on the back of the drive.

1. Connect the LaCinema Black RECORD to the TV, digital television (optional), and power supply as described in sections 3.1, 3.2, and 3.3, and 3.4.
2. A startup screen will appear during product initialization (Fig. 16). This may take more than a minute.

[continued on the next page >>](#)



Fig. 16

1. Setup Wizard: Remote

The first screen shows you the main functions of the remote control (Fig. 17). For details on the remote control, see 2. *Using the Remote Control*.

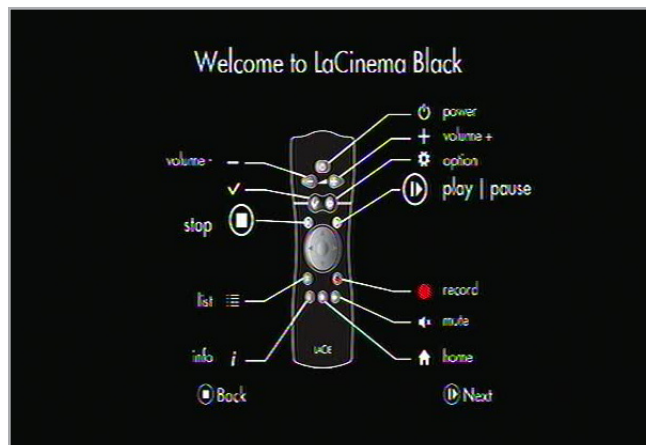

Fig. 17

2. Setup Wizard: Select your language

Use the Up ▲ and Down ▼ keys to select and Play/Pause/OK ►► to confirm (Fig. 18).



Fig. 18

3. Setup Wizard: Select your country

Use the Up ▲ and Down ▼ keys to select and Play/Pause/OK ►► to confirm (Fig. 19).



Fig. 19

4. Setup Wizard: Time zone

Defines the time zone applicable for your country to allow automatic updates for daylight savings time. Use the Up ▲ and Down ▼ keys to select and Play/Pause/OK ►► to confirm (Fig. 20).



Fig. 20

5. Setup Wizard: Date and Time

Use the Up ▲ and Down ▼ keys to select and Play/Pause/OK ►► to confirm (Fig. 21).

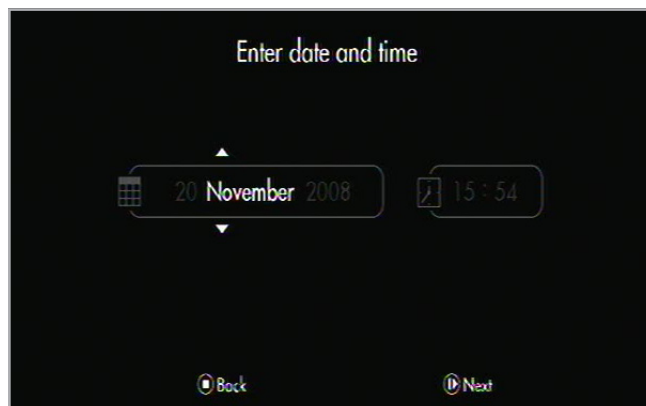

Fig. 21

6. Setup Wizard: TV Aspect Ratio

Use the Up ▲ and Down ▼ keys to select either "4:3 TV" or "16:9 Widescreen TV" and Play/Pause/OK ►► to confirm (Fig. 22).



Fig. 22

7. Setup Wizard: Parental Control

Use the **Up ▲** and **Down ▼** keys to select and **Play/Pause/OK ►►** to confirm (Fig. 23). For more information on controlling access to files, refer to section 4.6. *Controlling Access to Files*.

8. Setup Wizard: Parental Rating

Use the **Up ▲** and **Down ▼** keys and **Play/Pause/OK ►►** to confirm to control access to programs.

9. Setup Wizard: Parental Control Code

Use the **Up ▲** and **Down ▼** keys to enter the parental control code and **Play/Pause/OK ►►** to confirm.



Fig. 23

You have now completed the main LaCinema Black RECORD configuration. From the [Home](#) menu that appears when the wizard has completed, press the [Options/Settings](#)  button to access the [Settings](#) menu to finish product installation and to define advanced parameters ([Fig. 24](#)).

Move on to the next step, STEP 6: Connect to Your Network.

The following section explains how to connect your LaCinema Black RECORD to your home network in order to transfer files.



Fig. 24



3.6. STEP 6: Connect to Your Network

The LaCinema Black RECORD helps you select and configure your home network connection. Choose to connect with an Ethernet or wireless network and follow the steps below depending on your choice.

3.6.1. Wireless Network Connection

The LaCinema Black RECORD has a built-in WiFi antenna. When connecting to your network via wireless, the LaCinema Black RECORD helps you select, connect with, and configure your network connection.

Use the remote control to:

1. Go to [Home](#) menu and enter the [Settings Space](#) by pressing the [Options/Settings](#)  button ([Fig. 25](#)).
2. Select the [Network](#) menu, press the [Down](#)  button and select [Configure Network](#).
3. Select [Wireless Connection Mode](#).
4. Select your wireless network from the list.
5. Enter the password if required.
6. Select the connection method, [Automatic](#) or [Manual](#).
 - ◆ In automatic, network parameters will be defined automatically.
 - ◆ If you choose manual, you will be asked to enter the LaCinema Black RECORD's IP address.

TECHNICAL NOTE: If network is not managed by DHCP, you may have to enter your IP address, subnet mask, router, and DNS addresses.

7. Once done, you will go to redirected to the [Settings Space](#) menu.
8. You can check the network by selecting [Connection](#) in the [Network](#) menu.

For details on how to transfer files from your computer to your LaCinema Black RECORD, see section [5.3.1. Network-Attached Hard Disk \(NAS\)](#).

NOTE: Have your network password (if you use one) and your LaCinema Black RECORD remote control handy.

IMPORTANT NOTE: Wired (Ethernet) and Wireless (WiFi) connections cannot be active at the same time.

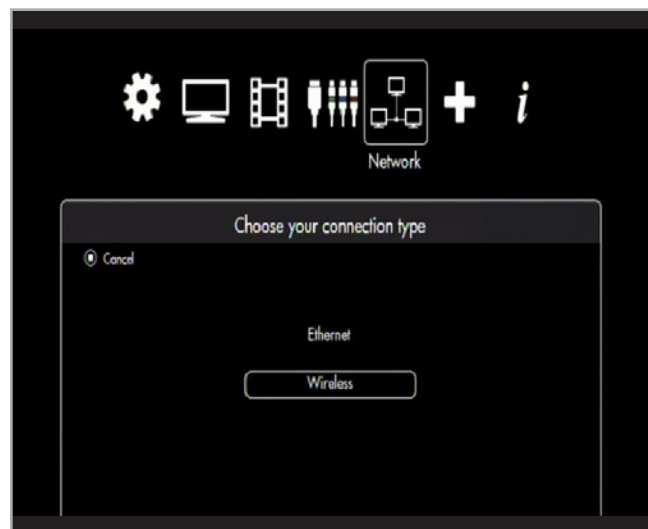



Fig. 25

3.6.2. Ethernet Network Connection

When connecting to your network via Ethernet, the LaCinema Black RECORD automatically detects your network.

Connect the Ethernet cable (not included) to the back of the LaCinema Black RECORD and to an Ethernet port on your router (Fig. 26).

1. Go to [Home](#) menu and enter the [Settings Space](#) by pressing the [Options/Settings](#)  button.
2. Select the [Network](#) menu, press the [Down](#)  button and select [Configure Network](#).
3. Select [Ethernet Connection Mode](#).
4. Select the connection method, [Automatic](#) or [Manual](#).
 - ◆ In automatic, network parameters will be defined automatically.
 - ◆ If you choose manual, you will be asked to enter the LaCinema Black RECORD's IP address.

TECHNICAL NOTE: If network is not managed by DHCP, you may have to enter your IP address, subnet mask, router, and DNS addresses.

5. Once done, you will go to redirected to the [Settings Space](#) menu.
6. You can check the network by selecting [Connection](#) in the [Network](#) menu (Fig. 27).

For details on how to transfer files from your computer to your LaCinema Black RECORD, see section [5.3.1. Network-Attached Hard Disk \(NAS\)](#).

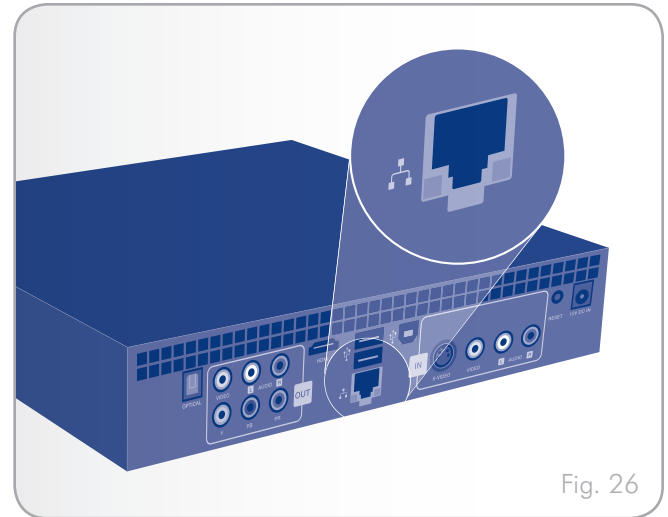

Fig. 26

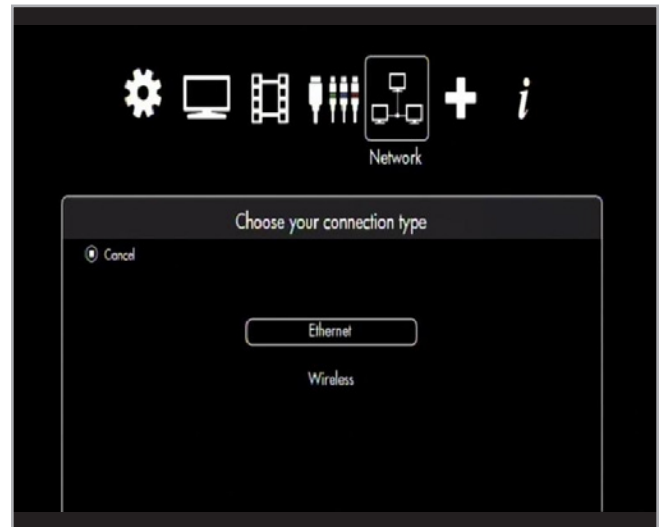

Fig. 27

4. Playing Multimedia Files

Thanks to the LaCinema Black RECORD's ability to connect to UPnP media servers, host computers, and external USB drives, you can access both files saved on the LaCinema as well as files located on these external sources on your television using the remote control.

From the [Home](#) menu, select one of the media spaces – [Movie](#), [Photo](#), [Music](#), [Browser](#), and [TV](#) – to access multimedia files. Files located on connected external sources can be accessed in the appropriate space.





The following section outlines how to play files for each media space. For details on connecting external sources to the LaCinema Black RECORD, such as a UPnP media server, a host computer, and/or an external USB drive, refer to chapter [5. Playing & Copying Files from External Sources](#).



4.1. Movie Space

Scroll through the menu using the navigation buttons. To confirm your choice and enter the [Movie Space](#), press the [Play/Pause/OK](#)  button ([Fig. 28](#)).

This menu will display all of the supported video files that you have uploaded to your LaCinema Black or located on an external source.

Only files recognized as video files will be displayed. Music and Photo files will not be displayed. To view all file types, select the [Browser Space](#).

You can scroll through the list of video files and folders using the [Up](#)  and [Down](#)  buttons, [Right](#)  button to open a folder and [Left](#)  to move to upper folder level ([Fig. 29](#)). To confirm your choice, press the [Play/Pause/OK](#)  button.

In the file list, you can retrieve file information by pressing the [Information](#)  button ([Fig. 30](#)). To exit the info screen, press the [Information](#)  button again.

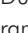
During the file playback, you can adjust several playback parameters. Press the [Options/Settings](#)  button to display or exit the on-screen menu.

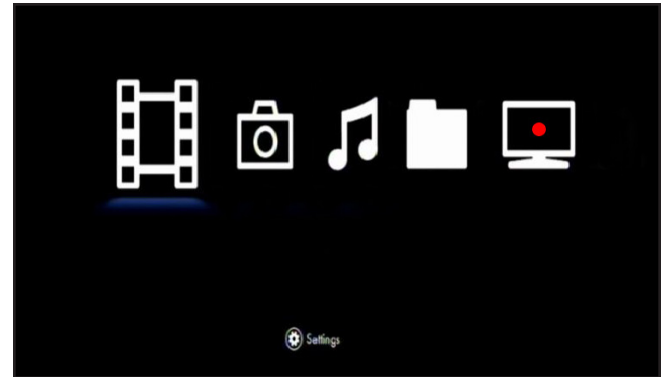

Fig. 28

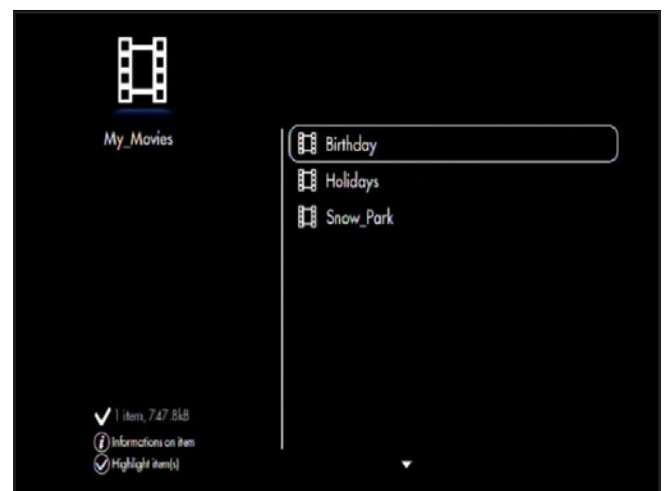

Fig. 29



Fig. 30

4.1.1. Display format

Select from these choices (Fig. 31):

- ◆ Original
 - ◆ Full Screen
 - ◆ Cinema
-

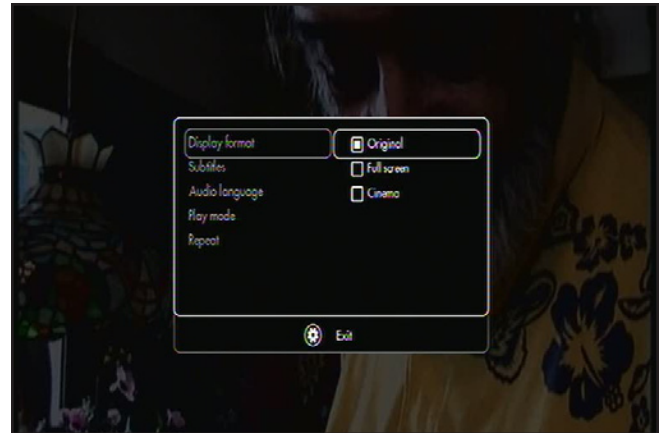

Fig. 31

4.1.2. Subtitle

- ◆ List of available subtitles (Fig. 32)
 - ◆ Off
-

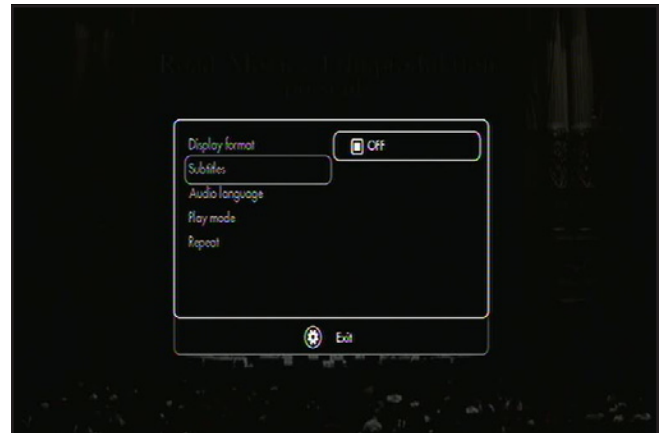

Fig. 32

4.1.3. Audio Languages

Select from the list of available languages (Fig. 33).



Fig. 33

4.1.4. Play mode

- ◆ One > Play selected file ([Fig. 34](#))
 - ◆ List > play all files from the directory
-



Fig. 34

4.1.5. Repeat

- ◆ Off > play once the select file or list of files ([Fig. 35](#))
 - ◆ On > play selected file or list of files in loop
-



Fig. 35

4.2. Photos Space

You can scroll through the menu using the navigation buttons (Fig. 36). To confirm your choice and enter a menu, press the **Play/Pause/OK** button.

This menu will display all of the image files that you have uploaded to your LaCinema Black RECORD. Only files recognized as image files will be displayed. Movies and music files will not be displayed. To view all file types, select the **Browser** Space.

You can scroll through the list of photos and folders using the **Up** and **Down** buttons, **Right** button to open a folder, and **Left** to move to a higher folder level (Fig. 37). To confirm your choice, press the **Play/Pause/OK** button.

During the file playback, you can adjust several playback parameters. Press the **Options/Settings** button to display or exit the on-screen menu.



Fig. 36

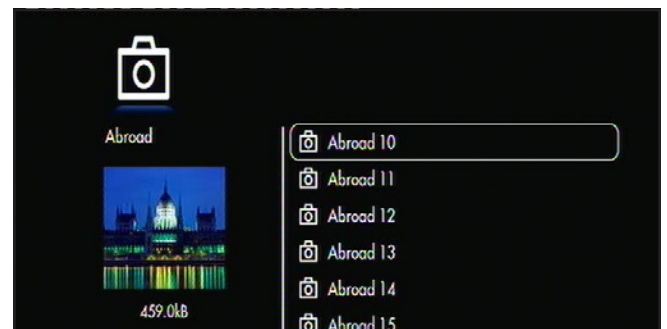

Fig. 37

4.2.1. Transition

This function allows you to define the transition effect between photos (Fig. 38).

4.2.2. Rotate Left / Rotate right

This function allows you to turn on automatic photo rotation to be displayed correctly on your TV (Fig. 39).

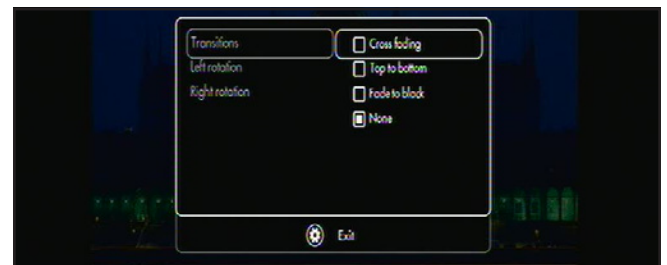

Fig. 38

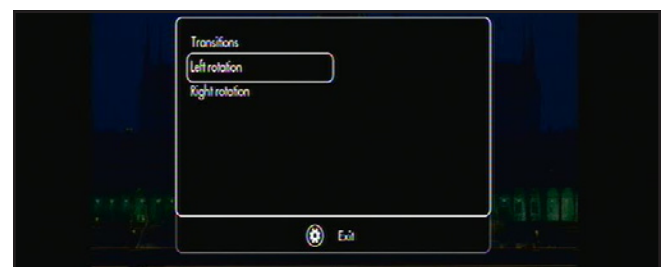

Fig. 39

4.3. Music Space

You can scroll through the menu using the navigation buttons (Fig. 40). To confirm your choice and enter a menu, press the **Play/Pause/OK** button.

This menu will display all of the audio files that you have uploaded to your LaCinema Black RECORD. Only files recognized as music files will be displayed. Movies and photo files will not be displayed. To view all file types, select the **Browser** Space.

You can scroll through the list of music tracks and folders using the **Up** and **Down** buttons, **Right** button to open a folder and **Left** to move to the upper folder level (Fig. 41). To confirm your choice, press the **Play/Pause/OK** button.

When the music player is started, you can pause or stop the current song. You can also change the track by scrolling through the list using the **Up** and **Down** buttons and pressing the **Play/Pause/OK** button.

During the file playback, you can adjust several playback parameters by pressing the **Options/Settings** button (Fig. 42). You will then enter the Music player where playlists can be edited on the fly and play mode adjusted.



Fig. 40

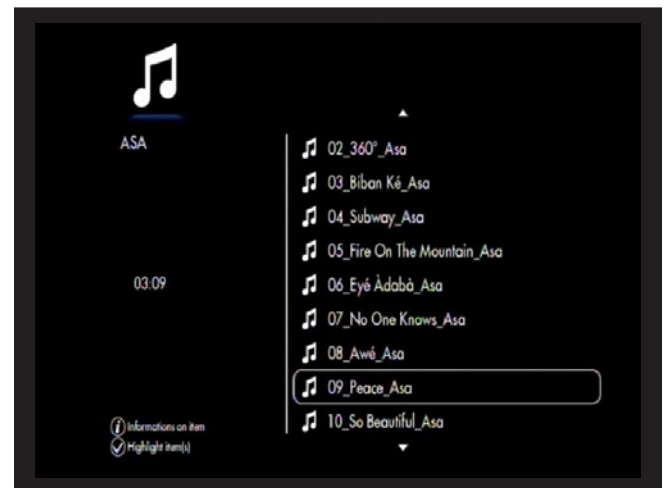

Fig. 41

4.3.1. Repeat

Set the repeat mode. Select **Track** to repeat the current song continually, **List** to repeat the songs in the folder continuously, and **Off** to stop playback at the end when all song in the folder have been played.

4.3.2. Random

Choose whether the tracks in a list should be played in a random order. Select **On** or **Off**.



Fig. 42

4.4. Playlist Management

Once the music player has started, you can create and edit playlists to arrange songs as you want. Press the **Right** ► key to enter the playlist management and **Left** ◀ key to close it and return to the player.

4.4.1. To Create a New Playlist

1. From the **Music Space**, mark the item you want to add to your list by selecting a track and pressing the **Mark** ✓ button. You can select files from different folders (Fig. 43).
2. Press the **Options/Settings** ⚙ button and select **Create Playlist with the Marked Items**.
3. Give the playlist a name and press the **Play/Pause/OK** ▶▶ button.

4.4.2. Change Playlist Track Order

To move a track in the list, press **Up** ▲ and **Down** ▼ to select it. Press **Right** ► to move it and then **Up** ▲ and **Down** ▼ to change its position in the list.

4.4.3. To Remove an Item from the Playlist

To remove an item from the playlist, press the **Stop** ■ button. This action does not delete the file but only removes it from the current playlist.

NOTE: The currently playing song cannot be removed from the list.



Fig. 43

4.5. Record Space

You can scroll through the menu using the navigation buttons (Fig. 44). To confirm your choice and enter a menu, press the Play/Pause/OK button.

If you have connected your LaCinema Black to a set top box, when you enter the Record Space, you will see live television.

For further details on watching and recording live television, refer to chapter 6. [Capturing Video from a TV or Camcorder](#).

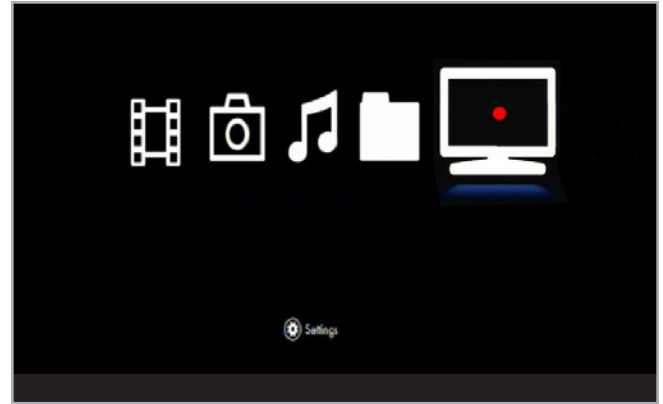



Fig. 44



4.6. Controlling Access to Files

You can control access to files by requiring a password to play files with certain ratings. The procedure consists of activating the service, defining an age threshold, then assigning ratings to files.

Follow these steps to control access:

1. Click the [Options/Settings](#)  button on your remote control.
2. Select [General](#), then [Access and protections](#), then [Parental control](#), and enable this function.
3. Enter your secret code, then enter a question that will be posed in the event that you forget your secret code.
4. Next, select [Set to Child Mode](#) and confirm this setting.
5. Next, click [Parental rating](#) and define an age threshold, outside of which a file can only be played if the correct password is given. For example, if your Child Mode level is set to -12, then any file tagged as -16 or above will not be available to be played unless a user types in the password set up in [General > Access and protections > Modify secret code](#).
6. Navigate to a file in one of the spaces, press the [Information](#)  button, then select an age level. If this age is above the level you set in the [Set to Child Mode](#) setting, it will become invisible until the age threshold is changed in the [Set to Child Mode](#) setting.

4.7. Deleting Files

1. Select a file or folder and press the [Mark](#)  button.
 2. Now click the [Options/Settings](#)  button on your remote control.
 3. From the menu, select [Delete marked items](#).
-

5. Playing & Copying Files from External Sources

5.1. USB Hard Drive

Simply turn on and plug in external hard disks to the LaCinema Black RECORD's front (Fig. 45) or rear (Fig. 46) USB ports to be able to play multimedia files on your television. See below for more details.

5.1.1. Connection

Power on the external hard disk and plug its USB cable into either the LaCinema Black RECORD's front or rear USB expansion slot. Once connected, a pop up message will notify you and show the storage volumes on the selected Space. You will be able to browse through the list of files.

NOTE: Only files supported in the current media space will be displayed (i.e., music files in the [Music Space](#)).

5.1.2. Compatibility

In addition to hard disks, you can also connect card readers, digital cameras, or digital camcorders with USB Mass storage support.

Hard drives with the following file system formats are supported: **FAT32, NTFS, HFS+, and Linux file systems (EXT 2, EXT3).**

5.1.3. Playing Files

Files located on the external volume will be listed alongside the locally stored files in the various Spaces. To play files, simply navigate to the proper Space, select the file, and press the **Play/Pause/OK** button (Fig. 47).

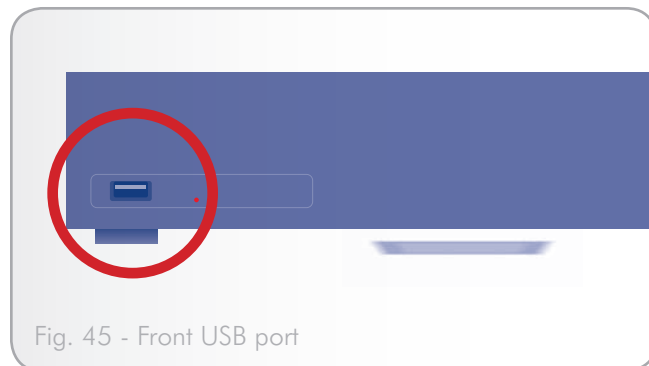

Fig. 45 - Front USB port



Fig. 46 - Rear USB ports

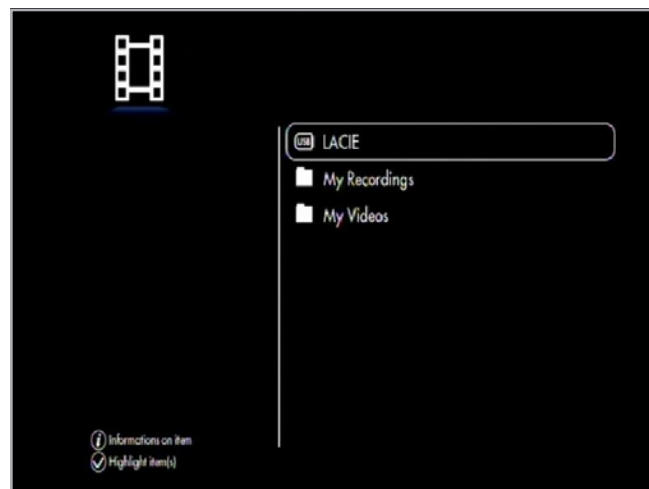

Fig. 47

5.1.4. Copying Files

1. Verify the external hard drive is connected (see section 5.1.1) and is recognized by the LaCinema Black RECORD.
2. Files located on the external hard drive will be listed alongside the locally stored files in the various Spaces. Select the file or folder to be copied and press the **Mark** ✓ button (Fig. 48).
3. Then, navigate to the directory where you'd like to copy the file and press the **Options/Settings** ⚙ button and select **Paste marked items to [Current Directory]**.
4. The file copy window will appear and show the copying progress.



Fig. 48

5.2. Transferring Files via USB (Requires Windows Media Player 11)

When you install Windows Media Player, drivers are also installed that allow your LaCinema Black RECORD to be connected to your computer via USB and mount similarly to an external hard drive. You will see its icon in [My Computer](#) (XP users) or [Computer](#) (Vista users). You can then transfer files from your computer to the LaCinema Black and vice versa in the same way as you would with a standard external hard drive.

1. Make sure that the software is installed on your computer.

TECHNICAL NOTE: WMP is preinstalled on Vista, but XP users may have to download and install the software.

2. Connect the LaCinema Black to your computer via the USB cable.

IMPORTANT INFO: Connecting your LaCinema Black RECORD directly to a host computer via USB is not supported for Mac OS X users.

3. In [My Computer](#) or [Computer](#), open the volume entitled [LaCinema Black](#) ([Fig. 49](#)).
4. Next, open the volume named [Local HDD](#) ([Fig. 50](#)).
5. Drag files from your local hard drive into one of the three folders according to the type of file (for instance, mp3 files go in [My Music](#), while jpg files go in [My Pictures](#)) ([Fig. 51](#)).

IMPORTANT INFO: Make sure to correctly categorize the files according to type, if you want the files to be available for playback on your TV.

TECHNICAL NOTE: The **Recording** folder is not accessible while the LaCinema Black is connected to computer. This folder is an optimized partition for recording and timeshifting. To copy recorded content, follow the procedure outlined in section [5.3.1.2. Copying Files](#).

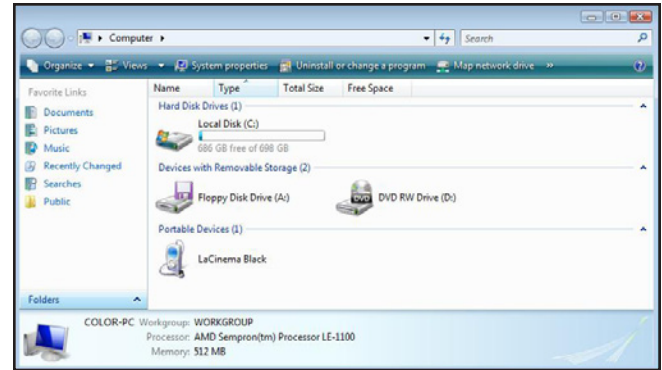

Fig. 49

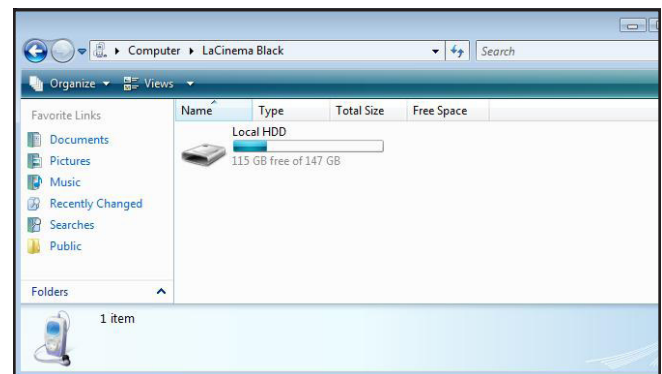

Fig. 50

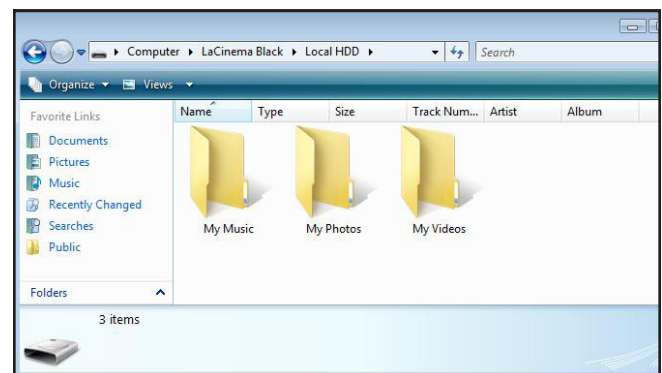

Fig. 51

5.3. Networked Media Server

You can stream content to your LaCinema Black RECORD from a networked UPnP server located on a host computer (Mac or PC) or a network-attached hard disk (NAS). For details, see below.

5.3.1. Network-Attached Hard Disk (NAS)

5.3.1.1. Playing Files

If you have a NAS running a media server, it is possible to stream this content to the LaCinema Black RECORD. In order to view your NAS content on LaCinema Black RECORD, first make sure that both devices are connected to the network (see Fig. 52). Once connected, files located on the NAS will appear in the various Spaces on the LaCinema Black RECORD.

5.3.1.2. Copying Files

1. Make sure that both the NAS and the LaCinema Black are connected to the network (Fig. 52).
2. Files located on the external volume will be listed alongside the locally stored files in the various Spaces. Select the file or folder to be copied and press the **Mark** ✓ button (Fig. 53).
3. Then, navigate to the directory where you'd like to copy the file and the press the **Options/Settings** ⚙ button and select **Paste marked items to [Current Directory]**.
4. The file copy window will appear and show the copying progress.

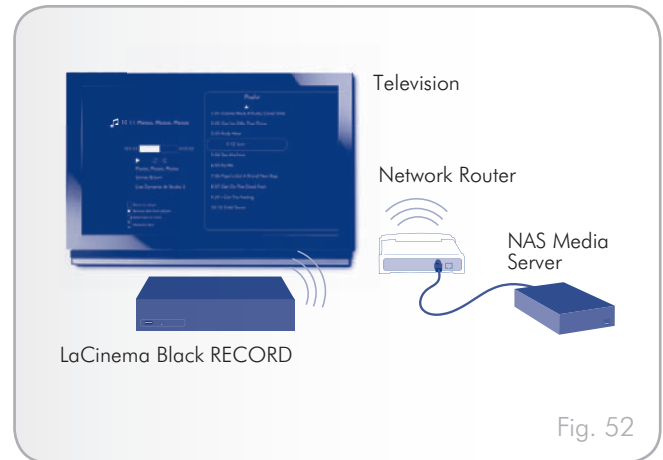

Fig. 52



Fig. 53

5.3.2. Host Computer

You can connect your LaCinema Black to a computer in order to stream or copy files.

- ◆ If you wish to connect via [USB](#), you must use Windows Media Player (see section [5.3.1. Network-Attached Hard Disk \(NAS\)](#)).
- ◆ If you choose a [Network](#) connection, you can either use TwonkyMedia server (see [5.3.2.1. Playing Files Using TwonkyMedia Server \(All users\)](#)) or Windows Media Player (Windows users only).

5.3.2.1. Playing Files Using TwonkyMedia Server (All users)

You can install software which will enable your PC or Mac to act as a UPnP media server. Once the software has been installed and configured, files located on the host computer will appear in the various Spaces on the LaCinema Black RECORD (see [Fig. 54](#)).

1. From the Utilities CD-ROM, install the Packet Video TwonkyVision software.
2. Once installed, launch the server from the Start Menu (Windows users) or the Applications folder (Mac users).
3. In the configuration page that opens in your web browser, click on the [Sharing](#) link and then select the folders on your computer that contain the multimedia content you wish to access from the LaCinema Black RECORD ([Fig. 55](#)). Make sure to click the [Save Changes](#) button when you finish.
4. It may be necessary to restart the server. To do so, select the [First Steps](#) link and click [Restart server](#).
5. You will now be able to access your computer's multimedia content using the LaCinema Black RECORD remote control. Files will appear in the various Spaces on the LaCinema Black RECORD.

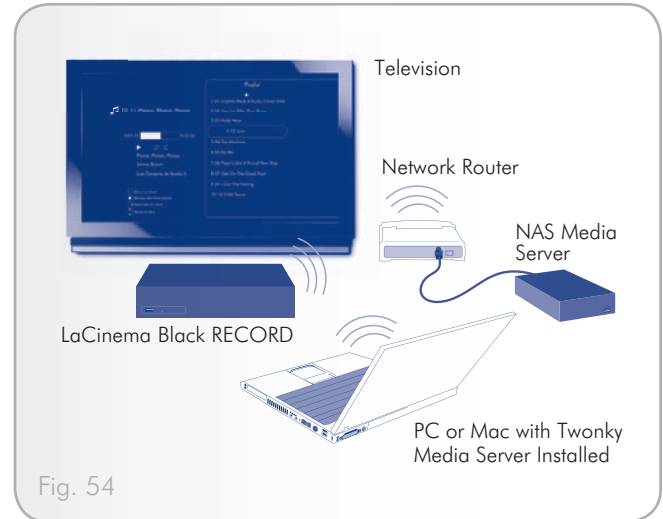

Fig. 54

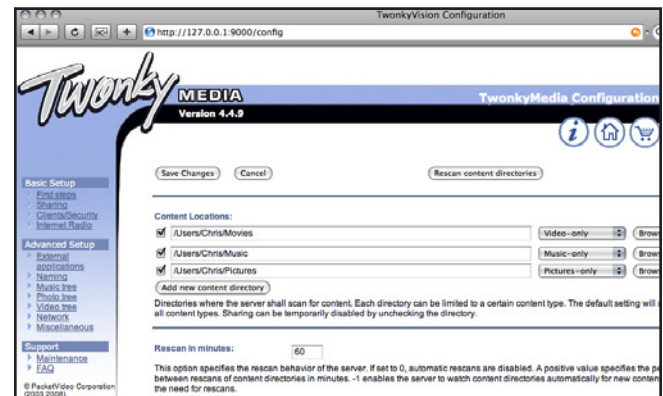

Fig. 55

5.3.2.2. Copying Files Using TwonkyMedia Server (All users)

1. Make sure that both the host computer and the LaCinema Black are connected to the network and the TwonkyMedia server has been set up as described in section [5.3.2.1](#).
2. Files located on the host computer will be listed alongside the locally stored files in the various Spaces on the LaCinema Black. Select the file or folder to be copied and press the [Mark](#) ✓ button ([Fig. 56](#)).
3. Then, navigate to the directory where you'd like to copy the file and the press the [Options/Settings](#) ⚙ button and select [Paste marked items to \[Current Directory\]](#).
4. The file copy window will appear and show the copying progress.



Fig. 56

5.3.2.3. Playing Files via the Network Using Windows Media Player (Windows Only)

Windows Media Player (WMP) 11 provides a network media server, which can use your LaCinema Black RECORD as a network media player. This allows you to play back files on your TV that are located on your computer, via the LaCinema Black RECORD. Follow these steps to configure the connection:

1. Make sure that the software is installed on your computer.

TECHNICAL NOTE: WMP is preinstalled on Vista, but XP users may have to download and install the software.

2. Make sure that both devices are connected to the network.
3. In WMP, turn on Media Sharing by clicking on **Library > Media Sharing...** (Fig. 57).
4. In the Media Sharing dialogue box, select **Share My Media to...** You must then tell WMP to share content with the LaCinema Black. Below the Share My Media check box, select the LaCinema Black RECORD and click **Allow** (Fig. 58).
5. Multimedia content imported into WMP will now be accessible in the various Spaces on the LaCinema Black RECORD.

5.3.2.4. Copying Files via the Network Using Windows Media Player (Windows Only)

1. Make sure the host computer and the LaCinema Black are connected to the network and WMP has been installed and configured (see 5.3.2.3).
2. Files located on the host computer will be listed alongside the locally stored files in the various Spaces on the LaCinema Black. Select the file or folder to be copied and press the **Mark ✓** button (Fig. 59).
3. Then, navigate to the directory where you'd like to copy the file and press the **Options/Settings ⚙** button and select **Paste marked items to [Current Directory]**.
4. The file copy window will appear and show the copying progress.

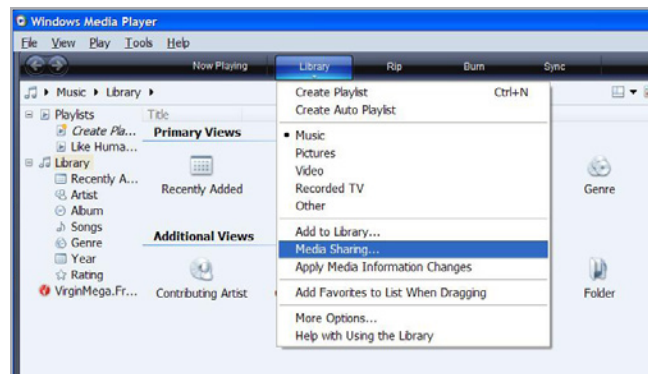

Fig. 57

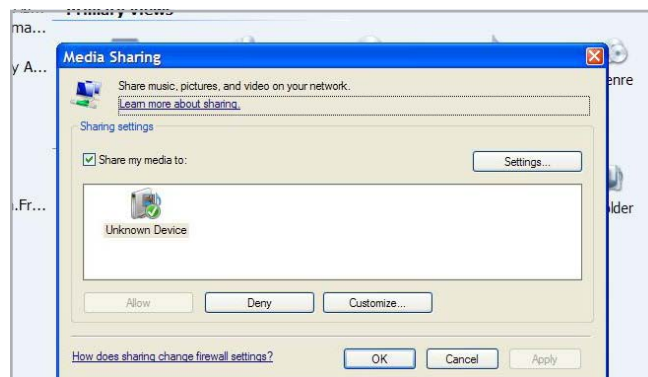

Fig. 58



Fig. 59

6. Capturing Video from a TV or Camcorder

The LaCinema Black RECORD can capture video from external devices such as a camcorder or set-top box.

6.1. Connect the External Video Source

Refer to section [3.2. STEP 2: Connect to Set-Top Box or Digital Camcorder \(Optional\)](#) for the procedure.

6.2. Recording Video

The LaCinema Black RECORD can record video input in two different ways:

- ◆ Instant recording
- ◆ Scheduled recording



6.2.1. Instant Recording



1. [From Camcorders:](#)
Connect (see chapter [3.2](#)) and play the video on your camcorder.

[From a Set-Top Box:](#)

Connect (see chapter [3.2](#)) and navigate to the channel on which the show you wish to record is playing.

2. Using the LaCinema Black RECORD remote control, press the **Record**  on your remote control to start capturing the video ([Fig. 60](#)).

The default recording length is for three hours and can be modified immediately after pressing the record button by using the **Up**  and **Down**  keys with 30 minute intervals.

During the recording, you can increase or reduce the recording length by pressing the **Record**  button again and then the **Up**  and **Down**  buttons.

TECHNICAL NOTE: Initially you may experience slow response time from the set-top box remote control when using the device in conjunction with the LaCinema Black RECORD. This is normal and will cease within a few moments.

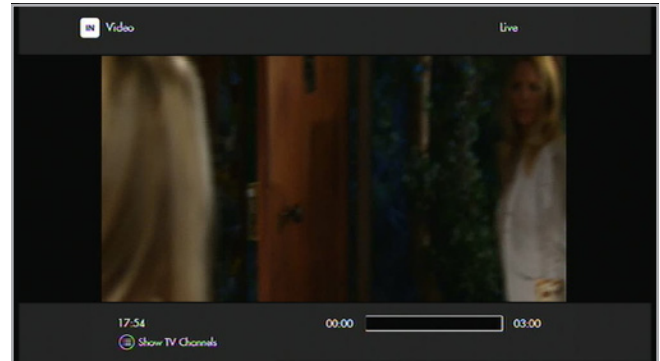



Fig. 60

3. You can then stop the recording when you wish to create the video file.

6.2.2. Scheduled Recording

Scheduled recording is very useful for recording repeating programs, such as a daily or weekly show.

To record a program, open the task window by pressing the [Options/Settings](#)  button and selecting [Manual Recording](#) and defining the following parameters ([Fig. 61](#)):

- ◆ Channel list containing the available sources
- ◆ Recording date
- ◆ Start and finish times
- ◆ Frequency
- ◆ Number of repetitions: the recording can be repeated several times

TECHNICAL NOTE: The device cannot record protected content sources such as commercial DVD-Video.

TECHNICAL NOTE: Pressing pause pauses the video on-screen, but doesn't stop the recording. Additionally, if you turn off the set-top box, the LaCinema Black will record a black screen.

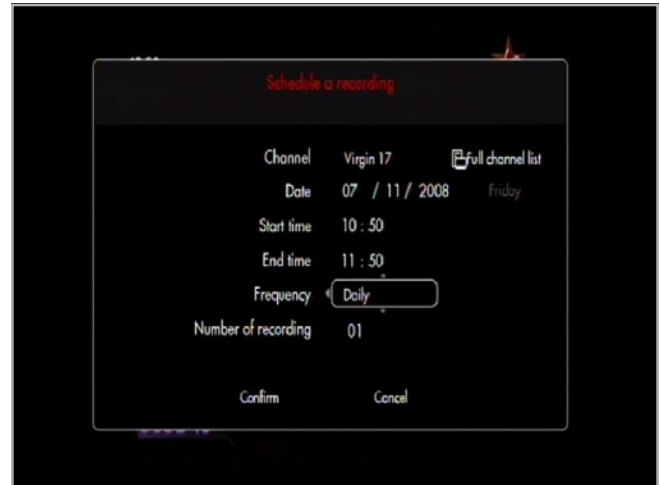

Fig. 61

6.2.3. Timeshifting: Taking Control of Live TV

One of the LaCinema Black RECORD's key benefits is the ability to pause and rewind live TV. The LaCinema Black RECORD automatically records TV as you are watching it, keeping the last three hours of recorded television. This buffer allows you to rewind up to three hours. If you rewind while watching live television, you can then fast-forward until you reach the live television time.

This icon in the information banner shows you that you are watching TV in timeshifting mode (Fig. 62).

Additionally, a progress bar shows you how far you are from the live television point.

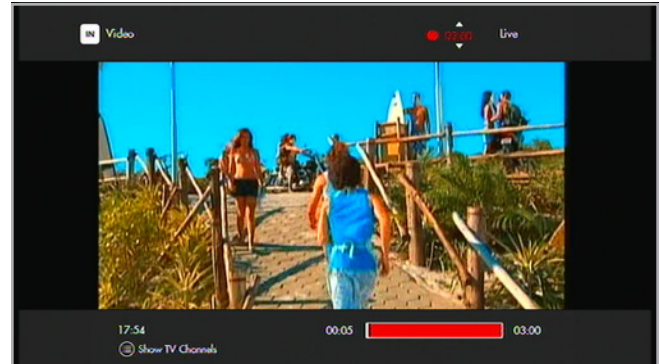



Fig. 62

6.2.4. Record Space Icon Details

Icon	Meaning
	You are watching live television
	You are timeshifting and watching recorded television
	You are recording
	Fast return/Forward during a program

6.3. Accessing Recorded Video

Recorded shows are saved in a predefined location that can be accessed from the [Movie Space](#) or [Browser Space](#).

Go to the [Home](#) menu, select the [Movie Space](#) or [Browser Space](#), and open the [My Recordings](#) folder ([Fig. 63](#)). This folder contains all recordings made with from Video IN capture (see section [6.2. Recording Video](#) for details). Press the [Play/Pause/OK](#)  button to start watching your video.

NOTE: Recordings can be exported to a PC or Mac by copying them to a USB hard disk for further editing or to be archived to a DVD.

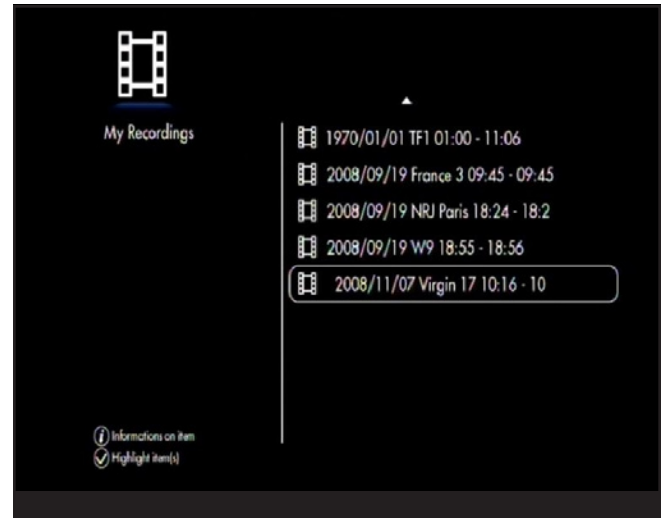





Fig. 63

7. Settings Menu

From the [Home](#) menu, access LaCinema Black RECORD settings by pressing the [Options/Settings](#)  button on the remote control.

7.1. Settings Menu Overview

Navigate through the settings categories using the [Left](#)  and [Right](#)  buttons and confirming using the [Play/Pause/OK](#)  button.

An info bar at the bottom of the screen provides the following information ([Fig. 64](#)):

- ◆ Current time and date
- ◆ Free space on the hard disk
- ◆ Network connection
- ◆ TV connection and resolution

A description of the settings categories follows.

7.1.1. Settings: General

Allows you to specify general parameters ([Fig. 65](#)):

- ◆ **Country** – Select your country for time and broadcasting preferences
- ◆ **Language** – Select the language for the on-screen menu
- ◆ **Date and Time** –
 - **Update mode** – defines how time is updated
 - **Manual** – User inputs time and date
 - **Automatic** – time and date updated from TV signal
 - **Date format** – Defines how time is displayed
 - Year/Month/Day
 - Day/Month/Year
 - Month/Day/Year
 - **Time format** –
 - 12 Hours
 - 24 Hours
 - **Time Set** – Set current Time and date (only available when Update mode is set to Manual)
 - **Time zone** – Define the time zone per Country / City

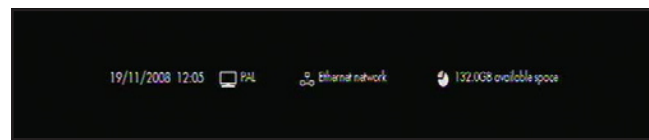

Fig. 64



Fig. 65

- ◆ **Access and Protections** –
 - **Parental control** – Enable or Disable parental control
 - **Set to child mode** – Turns Parental control on requiring secret code to enter some menus and some hidden files
 - **Modify secret code** – Enter current code and new code
 - **Modify answer/question** – Change the question that helps to remember the secret code
 - **Parental rating** – Defines age restriction for broadcasted shows
- ◆ **Help banner** – Enable or Disable Help banner during device use



Fig. 66

7.1.2. Settings: Video/Photo

Allows you to specify video and photo parameters (Fig. 66):

- ◆ **Video parameters** –
 - **Default audio track** –
 - French / English / Spanish
- ◆ **Slide Show Parameters** –
 - **Transitions** –
 - Without transition
 - Fade to black
 - Cross fading
 - Top to bottom

7.1.3. Settings: Connection

Allows you to specify video connection parameters (Fig. 67):

- ◆ HDMI/YUV output resolution
- ◆ Composite output
- ◆ Component output
- ◆ HDMI sound
- ◆ Automatic frame rate
- ◆ S/PDIF sound
- ◆ Aspect ratio



Fig. 67

7.1.4. Settings: Network

For basic network setup, refer to 3.6. *STEP 6: Connect to Your Network*.

7.1.5. Settings: Advanced

LaCinema Black reset – Pressing this button will cause all the settings to be reset and the installation wizard launched after automatic restart has concluded (Fig. 68).



Fig. 68

7.1.6. Settings: Version

Allows you to view (Fig. 69):

- ◆ Software version
- ◆ Serial number
- ◆ Copyright



Fig. 69

7.2. Firmware Update

The LaCinema Black RECORD allows you to update its firmware by loading downloaded firmware updates located on a connected USB external hard drive.

To update the firmware:

1. Go to www.lacie.com/support and click on the [Downloads](#) link.
2. Select and download the most recent LaCinema Black RECORD firmware.
3. Save the downloaded file to the top-most directory on an external hard drive volume (i.e. not within a folder on the volume).
4. Connect the external hard drive to the LaCinema Black RECORD.
5. Start the LaCinema Black RECORD.

IMPORTANT INFO: No other process should be running at the same time as the firmware update, such as recording or copying files.

6. The system will detect the new firmware file and offer to conduct an update ([Fig. 70](#)).
7. Accept the offer, and the update will begin ([Fig. 71](#)). Do not disconnect the USB external hard disk during the update.
8. Once the update is completed, the LaCinema Black RECORD will restart and confirm that the update was successful ([Fig. 72](#)).
9. Firmware information can be accessed from the [Settings](#) menu. From the [Home](#) menu, press the [Options/Settings](#)  button to access the [Settings Space](#). Go to the [Information](#) tab to display the current firmware version.

CAUTION: Never turn off the LaCinema Black RECORD during the Firmware Update process! Doing so may damage your device. If, for any reason, the procedure fails (e.g. a power failure occurs during the update), you may not be able to use your LaCinema Black RECORD. Please contact your reseller or LaCie Customer Support for more information.

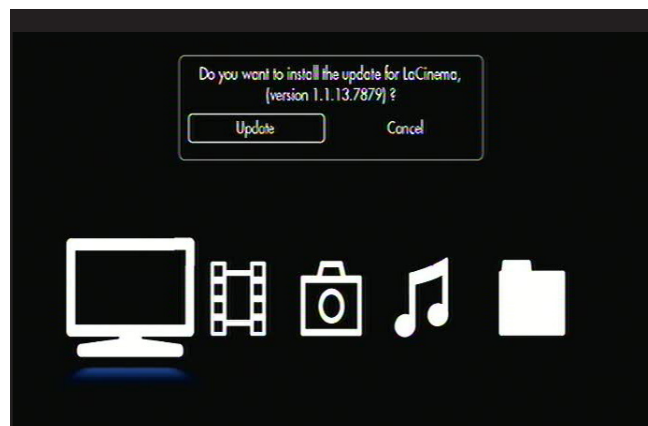

Fig. 70

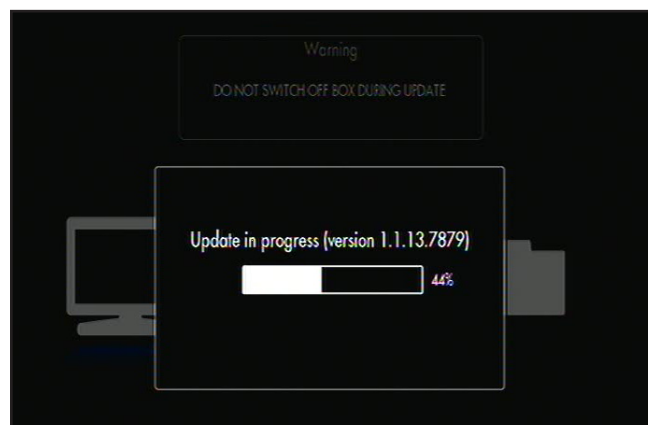

Fig. 71

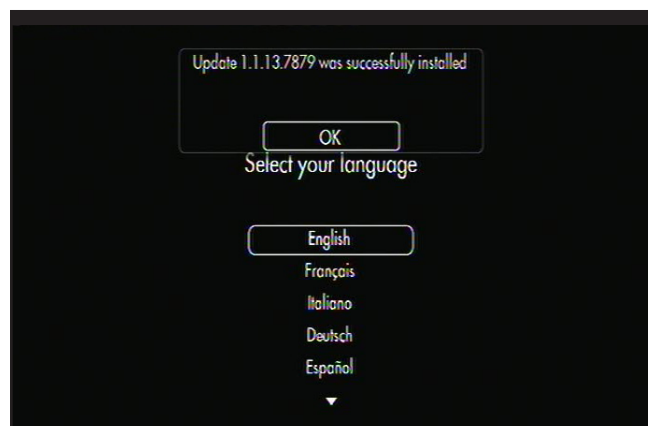

Fig. 72

8. Troubleshooting

If your LaCinema Black is not working correctly, please refer to the following checklist to determine the source of the problem. If you have gone through all of the points on the checklist and your LaCinema Black still does not work properly, please check the FAQs that are regularly published on our website – www.lacie.com. One of these FAQs may provide an answer to your specific question. You can also visit the downloads page, where the most recent software updates will be available.

If you need further assistance, please contact your LaCie reseller or LaCie Customer Support (see section 9. [Contacting Customer Support](#) for details).

Manual Updates

LaCie strives to give you the most up-to-date, comprehensive user manuals available on the market. It is our goal to provide you with a friendly, easy-to-use format that will help you quickly install and utilize the many functions of your new device.

If your user manual does not reflect the configuration of the product you purchased, please check our website for the most current version of the user manual.

www.lacie.com

Problem	Question	Answer
Checking the firmware version.	How do you know which firmware version your LaCinema Black is using?	To check which firmware is currently installed on your LaCinema Black, use the remote control to navigate to the Settings > Version menu. The firmware version will be displayed.
	How do you get new firmware, and how do you install it?	For a detailed explanation, please see section 7.2. Firmware Update or go to www.lacie.com .
DivX® and XviD® compatibility.	When a new version of DivX® or XviD® is released, will the LaCinema Black be able to play those files, too?	Provided that the new version complies with the ISO MPEG-4 standard, the LaCinema Black should be able to play the new versions.
	Does the LaCinema Black support external subtitles with DivX® files?	Yes, the LaCinema Black does support this functionality by using Unicode text files with extensions .sub (MicroDVD format) and .smi. In order to work correctly, use the same file name for both the video file and subtitle text file, and store both of them in the same folder location on your LaCinema Black. For example, if the file name of the video file is "Movie.avi," then you will need to re-name the subtitle text as either "Movie.sub" or "Movie.srt."

Problem	Question	Answer
TV picture distortion.	Are all of the cables connected correctly?	Ensure that all of the cables are connected correctly. Make sure that only one video signal cable is attached at a time. See section 3.1. STEP 1: Connect to TV .
	Do your TV video settings correspond to the video connection method you have used?	You can modify the video settings in the Settings Space to match your TV's settings and the video connection method. Using the remote control, click Options/Settings  , then Connection , then choose your options.
Audio problems.	Are the audio cables connected properly?	For composite, component, SCART, and S-Video connections, make sure that the stereo audio (red and white) connectors are plugged in.
	Does the file you're attempting to play have sound, or is it compatible with the LaCinema Black?	Check the file's audio codec against the list of compatible files (see section 1.2. Supported Formats).
My file won't play.	Is the file compatible with the LaCinema Black?	Check the file's audio codec against the list of compatible files (see section 1.2. Supported Formats).
Optimizing video connections.	What connectivity method will produce the best quality?	For optimal quality and performance, the best video connection is the HDMI cable (included).
Viewing photos.	Does it take several seconds to load a picture?	Depending on file size, photos may take several seconds to load properly. Reducing the photo's resolution will reduce the file size, as well, and allow the file to load faster.
"Empty Folder" message appears.	Are there compatible files in the appropriate folder?	<p>If you know that there are compatible files in the folder and they are not being displayed, move the power switch on the back of the LaCinema Black to the OFF position, wait several seconds, and then turn the LaCinema Black on. Your files should now be displayed.</p> <p>Make sure also that parental controls have not prevented the file from being displayed. See 4.6. Controlling Access to Files.</p>

9. Contacting Customer Support

Before You Contact Technical Support

1. Read the manuals.
2. Try to isolate the problem. If possible, make the drive the only external device on the CPU, and make sure that all of the cables are correctly and firmly attached.

If you have asked yourself all of the pertinent questions in the troubleshooting checklist, and you still can't get your LaCie drive to work properly, contact us at www.lacie.com. Before contacting us, make sure that you are in front of your computer and that you have the following information on hand:

Information	Where to Find Information
1. LaCie hard drive serial number	Located on a sticker at the back of drive or on the original packaging
3. Macintosh/PC model	Mac users: Click on the Apple icon in the menu bar and select About This Mac . Windows users: Right click My Computer and select Properties > General .
4. Operating system version	
5. Processor speed	
6. Computer memory	
7. The brands and models of other internal and external peripherals installed on your computer	Mac users: Click on the Apple icon in the finder bar and select About This Mac . Select More Info... The Apple System Profiler will launch and will list your internal and external peripherals. Windows users: Right click My Computer and select Properties > Hardware .

9.1. LaCie Technical Support Contacts

LaCie Asia, Singapore, and Hong Kong Contact us at: http://www.lacie.com/asia/contact/	LaCie Australia Contact us at: http://www.lacie.com/au/contact/
LaCie Belgium Contact us at: http://www.lacie.com/be/contact/ (Français)	LaCie Canada Contact us at: http://www.lacie.com/caen/contact/ (English)
LaCie Denmark Contact us at: http://www.lacie.com/dk/contact	LaCie Finland Contact us at: http://www.lacie.com/fi/contact/
LaCie France Contact us at: http://www.lacie.com/fr/contact/	LaCie Germany Contact us at: http://www.lacie.com/de/contact/
LaCie Italy Contact us at: http://www.lacie.com/it/contact/	LaCie Japan Contact us at: http://www.lacie.com/jp/contact/
LaCie Netherlands Contact us at: http://www.lacie.com/nl/contact/	LaCie Norway Contact us at: http://www.lacie.com/no/contact/
LaCie Spain Contact us at: http://www.lacie.com/es/contact/	LaCie Sweden Contact us at: http://www.lacie.com/se/contact
LaCie Switzerland Contact us at: http://www.lacie.com/chfr/contact/ (Français)	LaCie United Kingdom Contact us at: http://www.lacie.com/uk/contact
LaCie Ireland Contact us at: http://www.lacie.com/ie/contact/	LaCie USA Contact us at: http://www.lacie.com/contact/
LaCie International Contact us at: http://www.lacie.com/intl/contact/	

10. Warranty Information

LaCie warrants your drive against any defect in material and workmanship, under normal use, for the period designated on your warranty certificate. In the event this product is found to be defective within the warranty period, LaCie will, at its option, repair or replace the defective drive.

This warranty is void if:

- ◆ The drive was operated/stored in abnormal use or maintenance conditions;
- ◆ The drive is repaired, modified or altered, unless such repair, modification or alteration is expressly authorized in writing by LaCie;
- ◆ The drive was subjected to abuse, neglect, lightning strike, electrical fault, improper packaging or accident;
- ◆ The drive was installed improperly;
- ◆ The serial number of the drive is defaced or missing;
- ◆ The broken part is a replacement part such as a pickup tray, etc.
- ◆ The tamper seal on the drive casing is broken.

LaCie and its suppliers accept no liability for any loss of data during the use of this device, or for any of the problems caused as a result.

LaCie will not, under any circumstances, be liable for direct, special or consequential damages such as, but not limited to, damage or loss of property or equipment, loss of profits or revenues, cost of replacement goods, or expense or inconvenience caused by service interruptions.

Any loss, corruption or destruction of data while using a LaCie drive is the sole responsibility of the user, and under no circumstances will LaCie be held liable for the recovery or restoration of this data.

Under no circumstances will any person be entitled to any sum greater than the purchase price paid for the drive.

To obtain warranty service, call LaCie Technical Support. You will be asked to provide your LaCie product's serial number, and you may be asked to furnish proof of purchase to confirm that the drive is still under warranty.

All drives returned to LaCie must be securely packaged in their original box and shipped with postage prepaid.

IMPORTANT INFO: Register online for free technical support:
www.lacie.com/register
